

**CAUTION!** Always use care and wear appropriate PPE when working with chemicals!

## 1 Install and Connect

- A. Mount SLX enclosure to wall
- B. Flush supply lines
- C. Connect water (1/2" FNPT)
- D. Connect discharge hose
- E. Place chemical container below unit and drop in suction line

### Example Installation

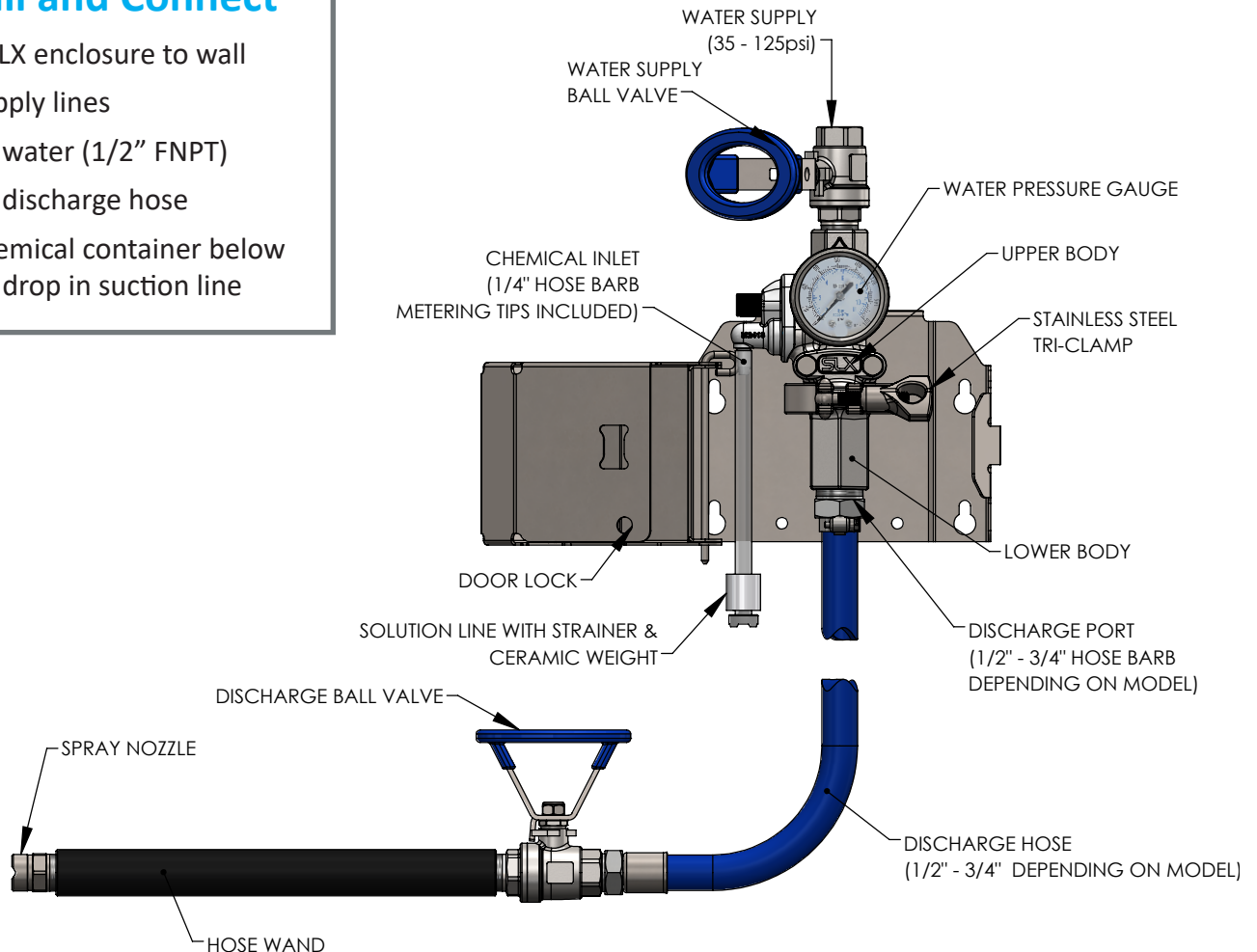

## 2 Dilution

- A. Select a metering tip for desired dilution ratio
- B. Install the metering tip by screwing it onto the hose barb for the chemical inlet
- C. Install chemical suction line to hose barb
- D. Connect suction line to chemical solution

**Metering Tip Calculator  
Mobile App:**



## 3 Operation

- A. Take hold of spray wand
- B. Open discharge ball valve
- C. Open water supply valve - unit will spray
- D. Verify water pressure is **at least 35 PSI**
- E. Spray/Sanitize
- F. When complete, turn off water supply valve
- G. Store rinsed hose depressurized, with discharge valve open, and coiled properly to prevent kinks

Parts will vary depending on model configuration.  
Please consult User Manual or contact us for more details.

**View User Manual for More Details:**



**Purchase Replacement Parts:**

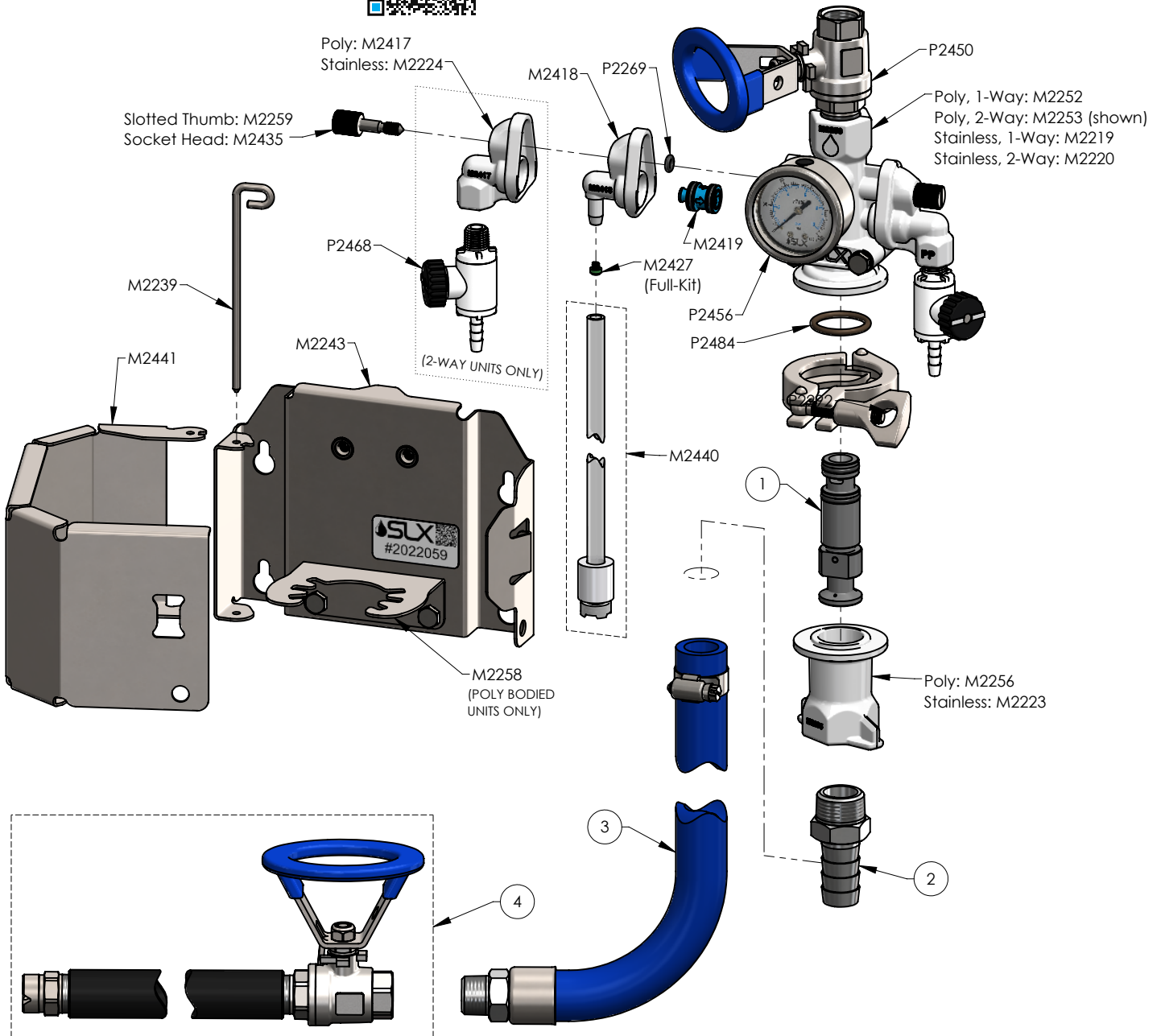

Insert Size	Flow Rate (GPM)	(1) Insert #	(2) Hose Barb #	(3) Hose #		(4) Wand #	
				Blue	Red	Poly	Stainless
V42	4.2	M2330	M2424	M2269	M2270	M2336	M2337
V54	5.4	M2331	M2425	M2273	M2274	M2336	M2337
V107	10.7	M2332	M2425	M2273	M2274	M2336	M2337