



**CAUTION!** Always use care and wear appropriate PPE when working with chemicals!

## Example Installation

### 1 Install and Connect

- A. Mount SLX enclosure to wall
- B. Flush supply lines
- C. Connect supply lines:
  - Compressed air (1/4" FNPT)
  - Water (1/2" FNPT)
- D. Connect discharge hose
- E. Place chemical container below unit and drop in suction line

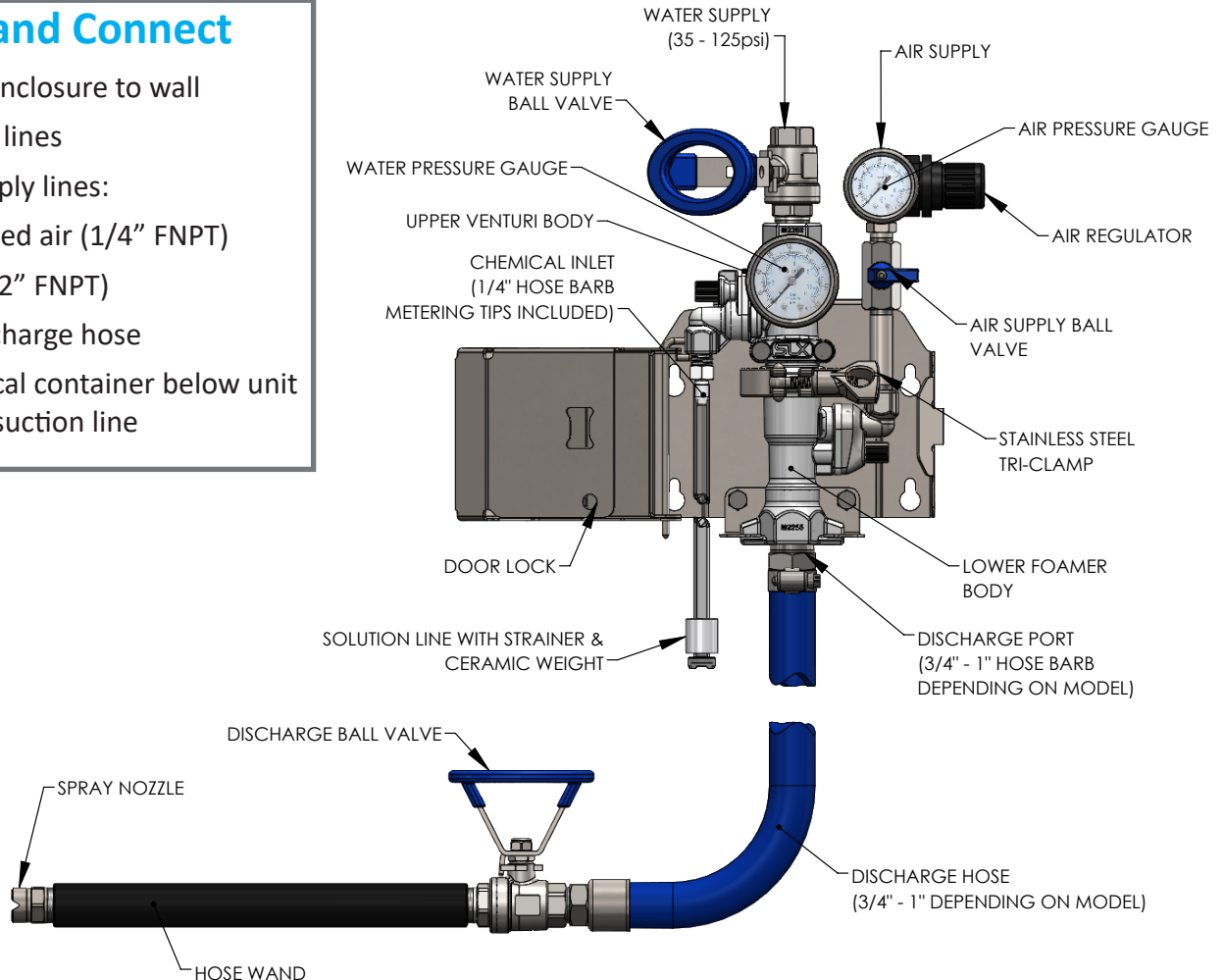

### 2 Dilution

- A. Select a metering tip for desired dilution ratio
- B. Install the metering tip by screwing it onto the hose barb for the chemical inlet
- C. Install chemical suction line to hose barb
- D. Connect suction line to chemical solution

**Metering Tip Calculator  
Mobile App:**

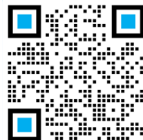

### 3 Operation

- A. Take hold of spray wand
- B. Open discharge ball valve
- C. Open water supply valve - unit will spray
- D. Verify water pressure is **at least 35 PSI**
- E. Open air supply valve - unit will foam
- F. Adjust air pressure to alter foam quality
- G. Foam equipment and rinse before it dries
- H. When complete, turn off supply valves
- I. Store rinsed hose depressurized, with discharge valve open, and coiled properly to prevent kinks

Parts will vary depending on model configuration.  
Please consult User Manual or contact us for more details.

**View User Manual for  
More Details:**

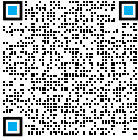

**Purchase Replacement Parts:**

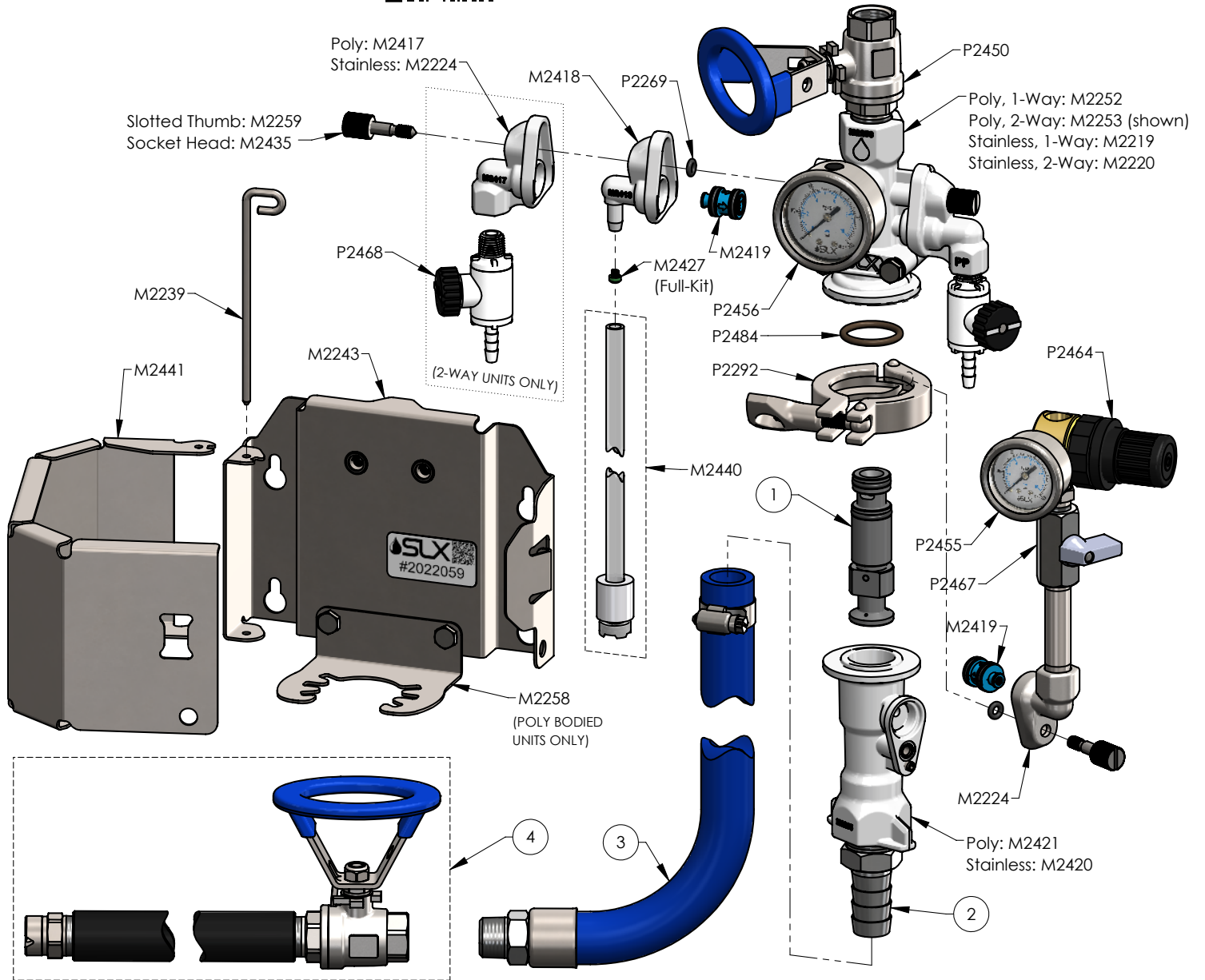

| Insert Size | Flow Rate (GPM) | (1) Insert # | (2) Hose Barb # | (3) Hose # | (4) Wand # |           |
|-------------|-----------------|--------------|-----------------|------------|------------|-----------|
|             |                 |              |                 |            | Poly       | Stainless |
| V06         | 0.6             | M2324        | M2425           | M2272      | M2338      | M2339     |
| V14         | 1.4             | M2325        | M2425           | M2273      | M2340      | M2341     |
| V37H        | 3.7             | M2329        | M2426           | M2277      | M2342      | M2343     |
| V42         | 4.2             | M2330        | M2426           | M2277      | M2342      | M2343     |