



CAUTION! Wear appropriate PPE when working with chemicals.

1 Install and Connect

- A. Mount SLX enclosure to wall
- B. Flush supply lines
- C. Connect supply lines:
 - Compressed air (1/4" FNPT)
 - Pump supply 2x (1/2" FNPT)
- D. Connect discharge hoses

Example Installation

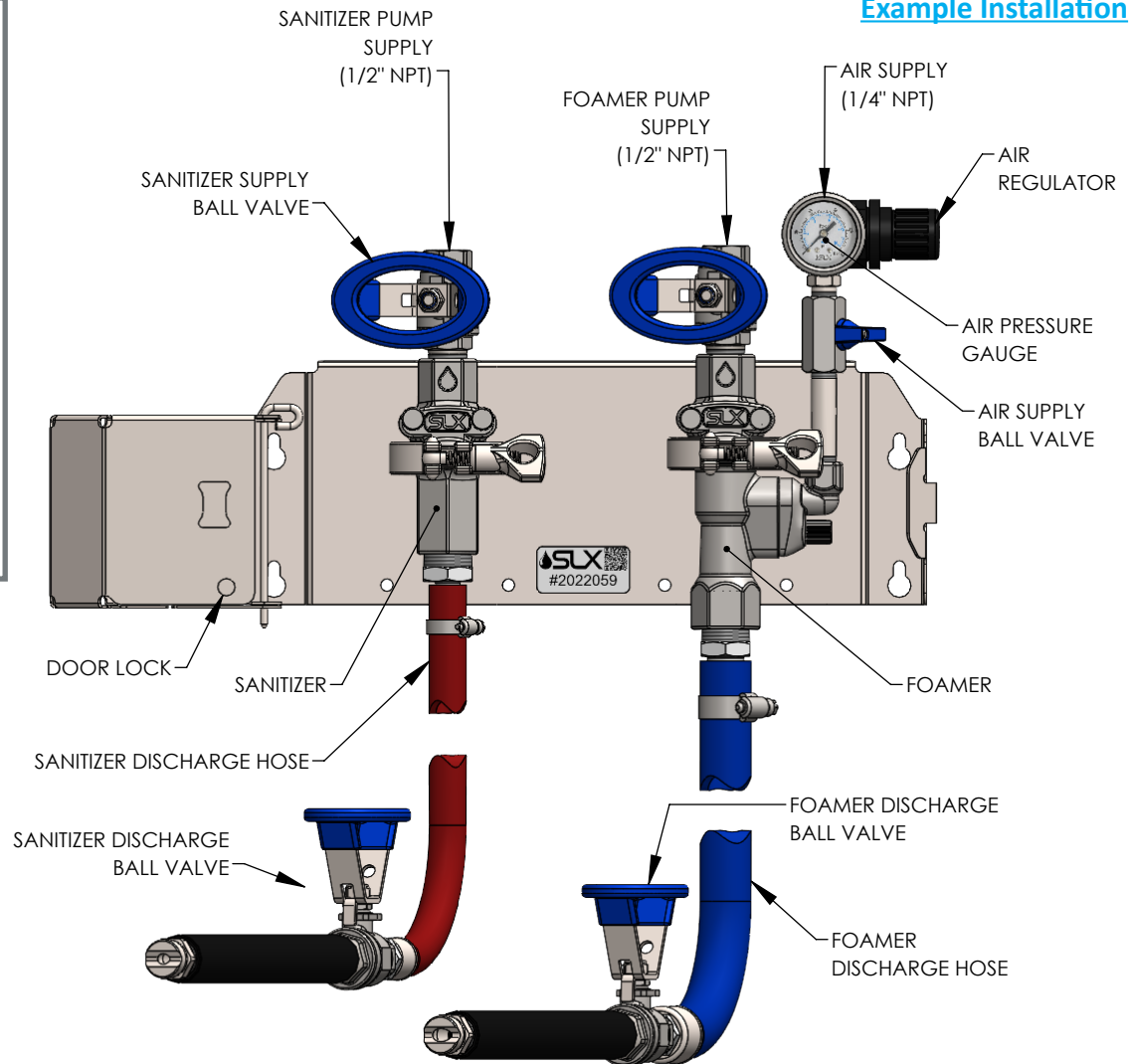

2 Operation

- A. Take hold of spray wand of any station
- B. Open discharge ball valve
- C. Open pump supply valve for the station - unit will spray
- D. [Foamers] Open air supply valve - unit will foam
- E. [Foamers] Adjust air pressure to alter foam quality
- F. Foam equipment, from bottom to top, and rinse before it dries
- G. Sanitize equipment, from top to bottom
- H. When complete, turn off supply valves for all stations
- I. Store rinsed hoses depressurized, with discharge valves open, and coiled properly to prevent kinks



CAUTION! Wear appropriate PPE when working with chemicals.

Parts will vary depending on model configuration.

Please consult User Manual or contact us for more details.

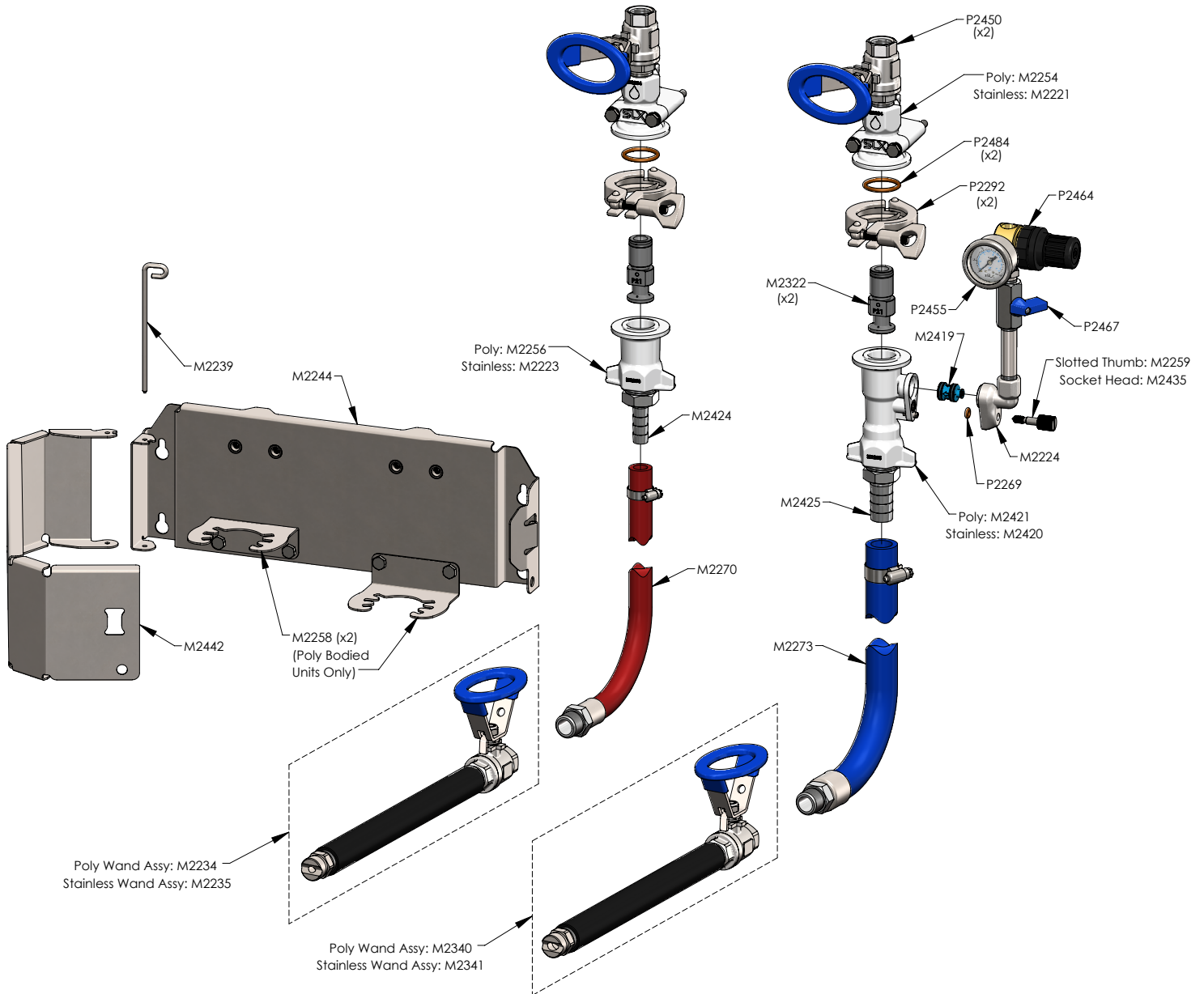

Purchase Replacement Parts:



**View User Manual for
More Details:**

