

**CAUTION!** Always use care and wear appropriate PPE when working with chemicals!

- ## 1 Install and Connect
- Mount SLX plate to wall
  - Flush supply lines
  - Connect supply lines:
    - Compressed air (1/2" tube)
    - Pump supply (1/2" FNPT)
  - Connect discharge hose to spreader nozzle and hose barb on foamer on foamer
  - Mount the spreader nozzle to wall near door
    - P14:** 4.5" height
    - P21 or P46:** 5-6" height

### Example Installation

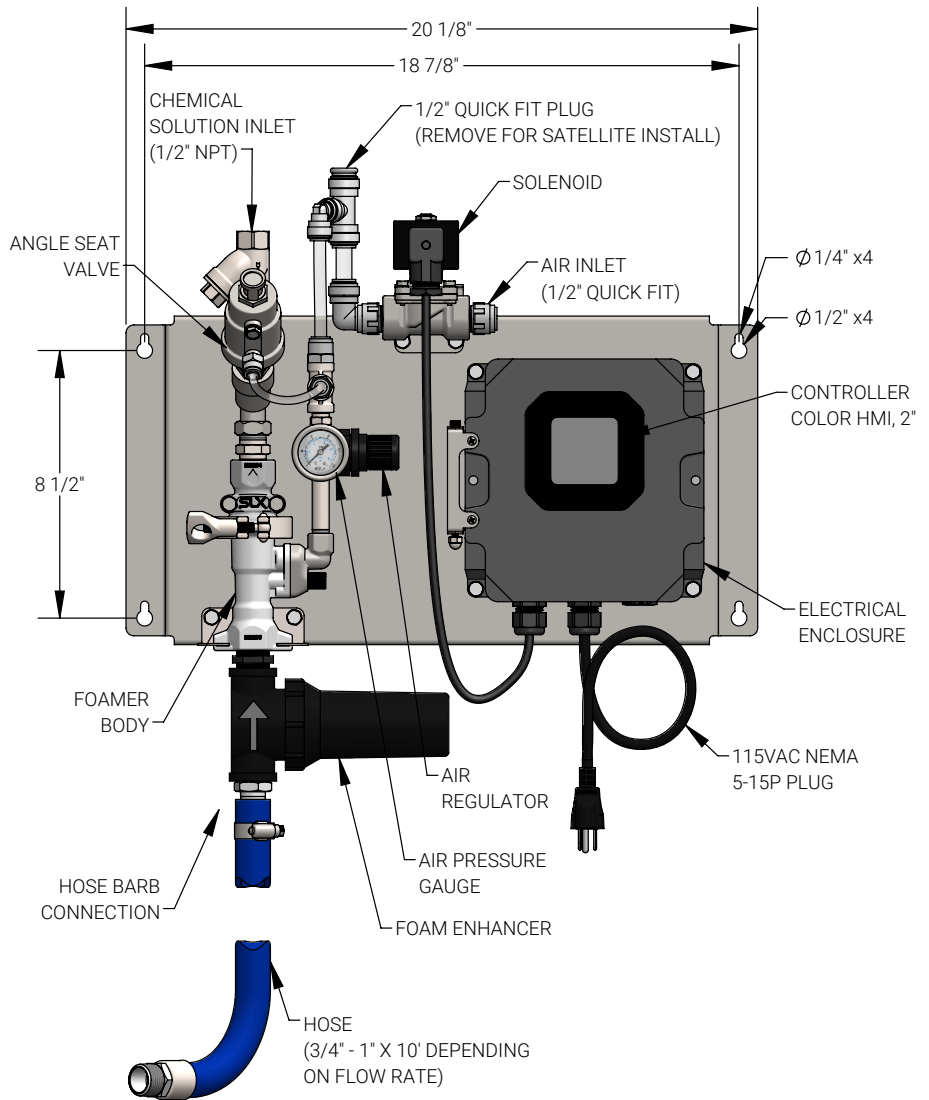

Controller Mobile App:

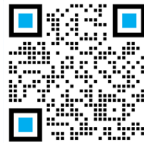

- ## 2 Operation
- Plug in power cord, 115VAC
  - Adjust timer for activation and interval settings  
*Default: 10 sec. on / 15 min. off*
  - Engage pump and air supply
  - Press **START** to activate system
  - Observe foam consistency - adjust air pressure as needed (min pump supply pressure 35 PSI)
  - Press **BOOST** to reduce interval time
  - Press **START** again to halt system

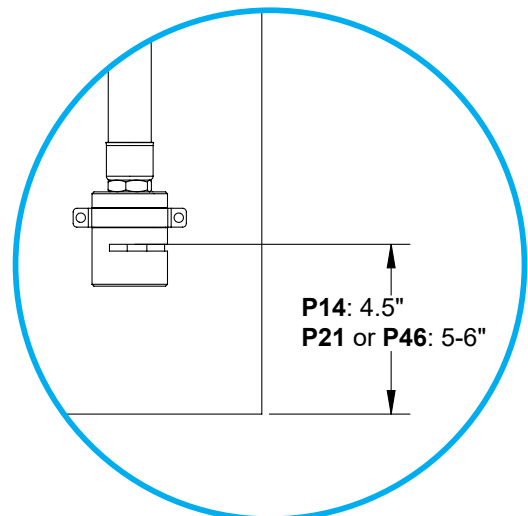

Parts will vary depending on model configuration.  
Please consult User Manual or contact us for more details.

### Purchase Replacement Parts:

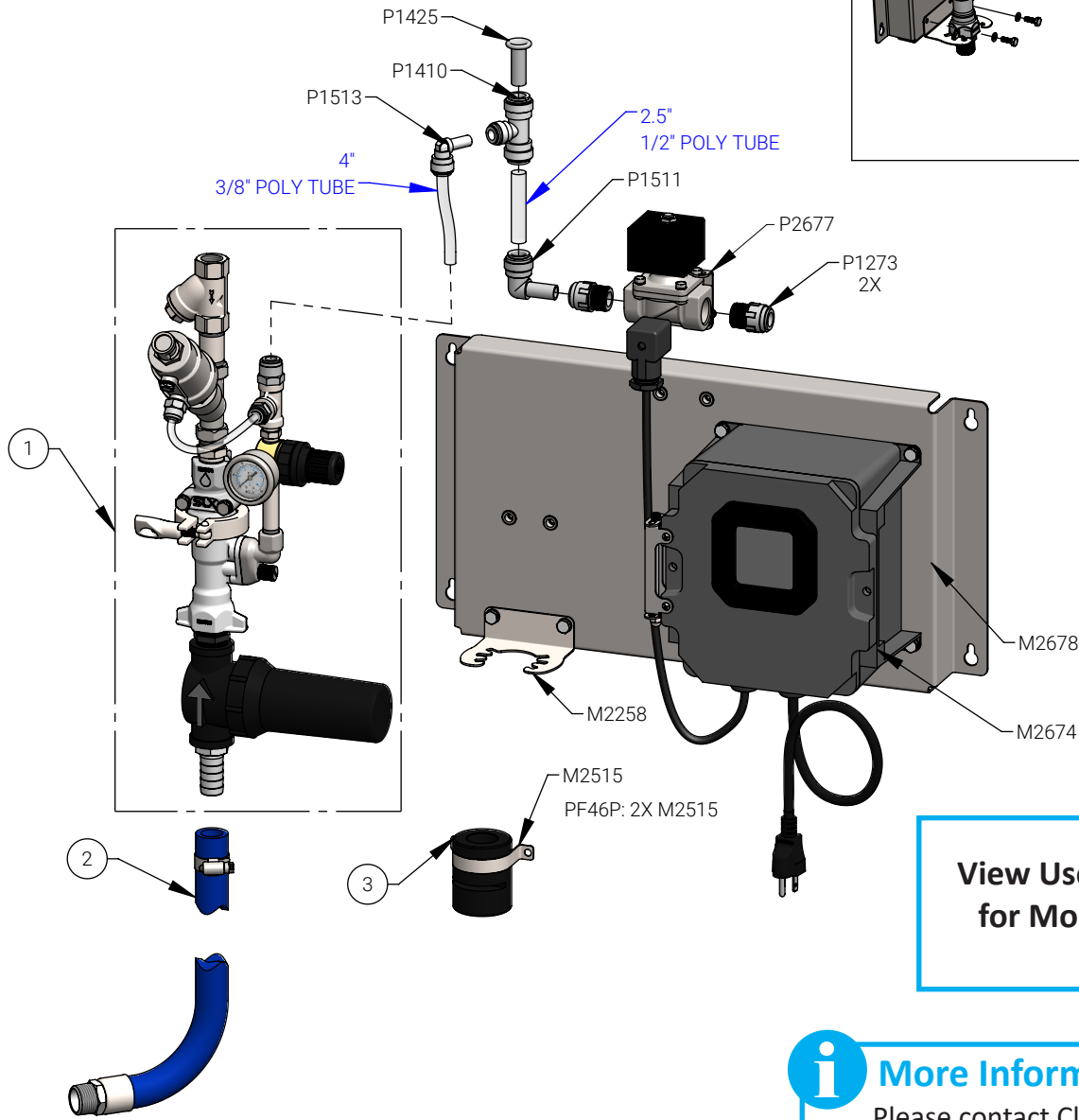
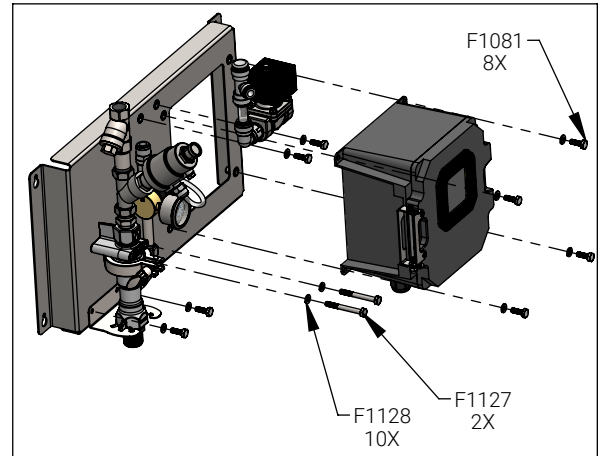

**View User Manual for More Details:**

**More Information**  
Please contact Clean Logix at:  
**(616)-438-9200** or [sales@clean-logix.com](mailto:sales@clean-logix.com)

Insert Size	Flow Rate GPM @ 40 PSI	(1) Foamer Stack Assembly	(2) Hose Assembly	(3) Nozzle #
P14	1.4	M2748	M2693	M2512
P21	2.1	M2749	M2692	M2513
P46	4.6	M2750	M2692	M2514