

**CAUTION!** Wear appropriate PPE when working with chemicals. Backflow prevention required.

## Example Installation

### 1 Install and Connect

- A. Mount SLX enclosure to wall
- B. Flush supply lines
- C. Install backflow prevention per local guidelines
- D. Connect water supply line (3/4" FNPT)
- E. Connect discharge hoses
- F. Connect discharge wands
- G. Place chemical container below unit and drop in suction line

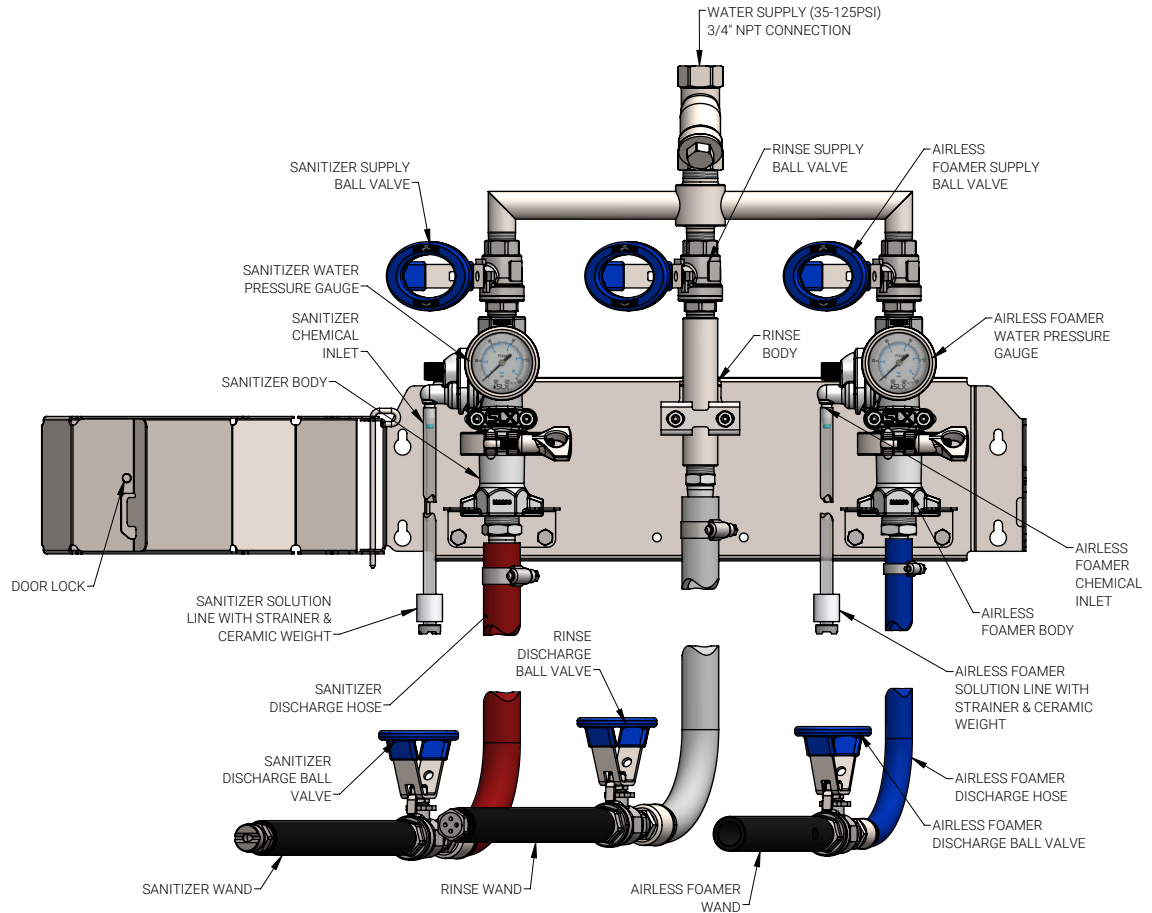

### 2 Dilution

- A. Select a metering tip for desired dilution ratio
- B. Install the metering tips by screwing it onto the hose barbs for each chemical inlet
- C. Install chemical suction lines to hose barbs
- D. Connect suction lines to chemical solution

**Metering Tip Calculator  
Mobile App:**

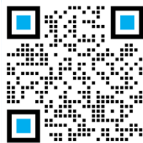

### 3 Operation

- A. Take hold of spray wand for one of the three systems
- B. Open discharge ball valve
- C. Open water supply valve - unit will spray
- D. Verify water pressure is **at least 35 PSI**
- E. Foam equipment, from bottom to top, and rinse before it dries
- F. Sanitize from top to bottom
- G. When complete, turn off supply valves
- H. Store hose depressurized, with discharge valve open, and coiled properly to prevent kinks

Purchase Replacement Parts:



View User Manual for More Details:



**WARNING:**  
A BACKFLOW PREVENTER IS REQUIRED AND  
MUST BE SUPPLIED BY THE END USER. FOLLOW  
ALL LOCAL CODES.

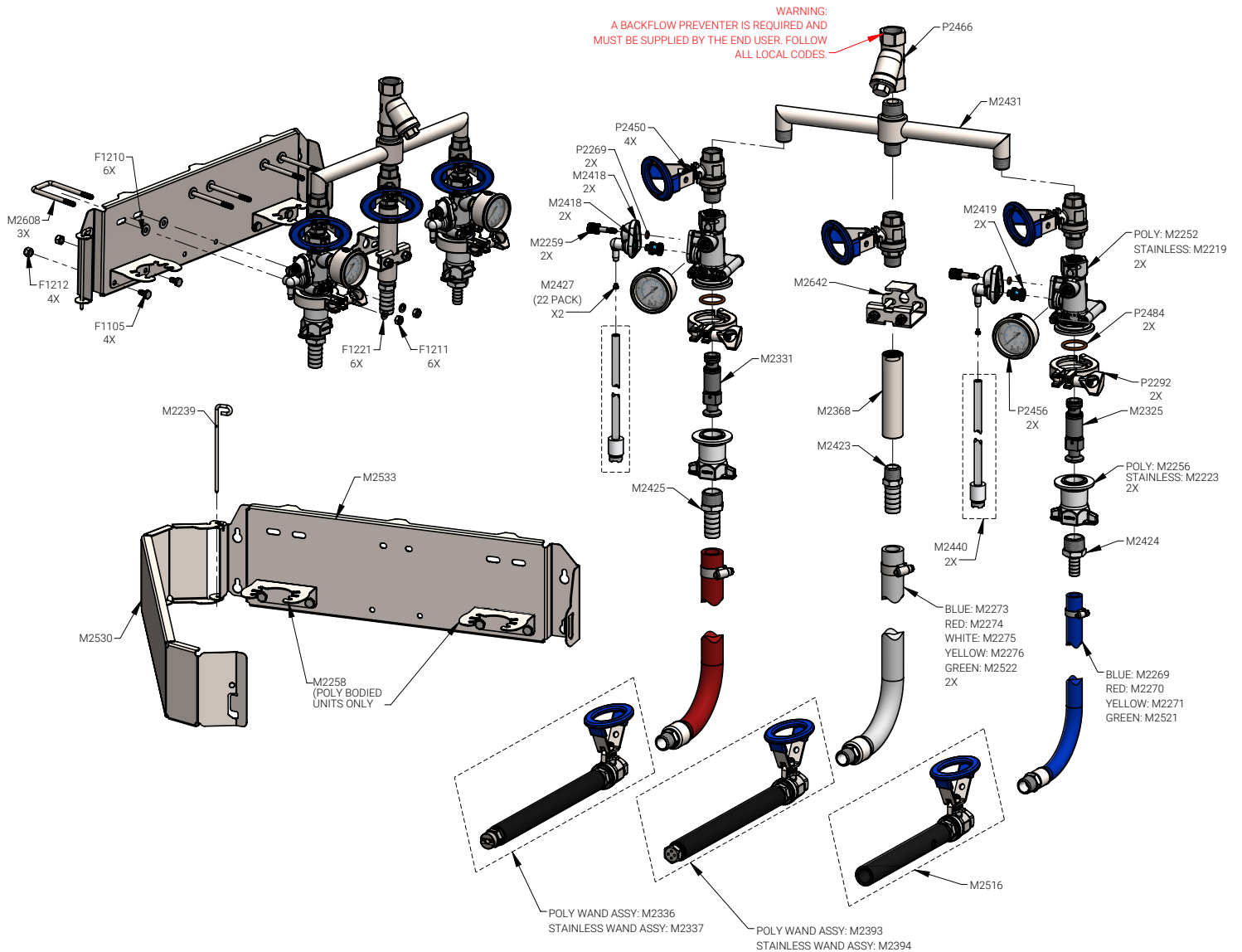

**i More Information**  
Please contact Clean Logix at:  
**(616)-438-9200** or [sales@clean-logix.com](mailto:sales@clean-logix.com)

