



---

# USER MANUAL

---

MODEL:

**PBX-CAB-25**

**1/4" Pump Cabinet**

---

*English (Original Instructions)*

*Updated: 03/25/21*

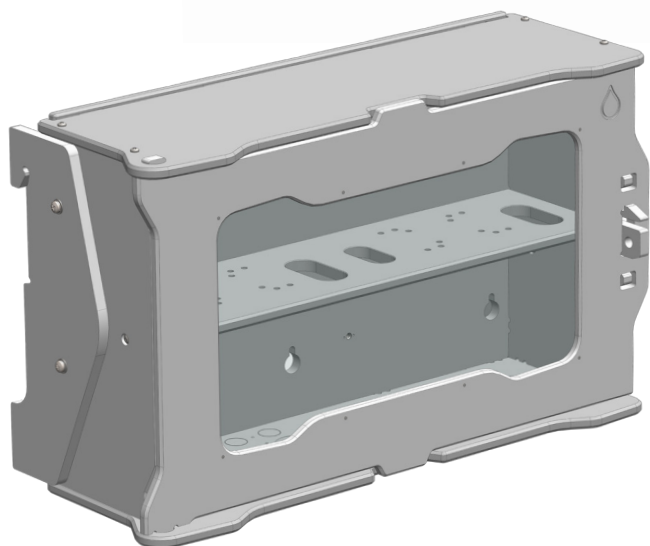
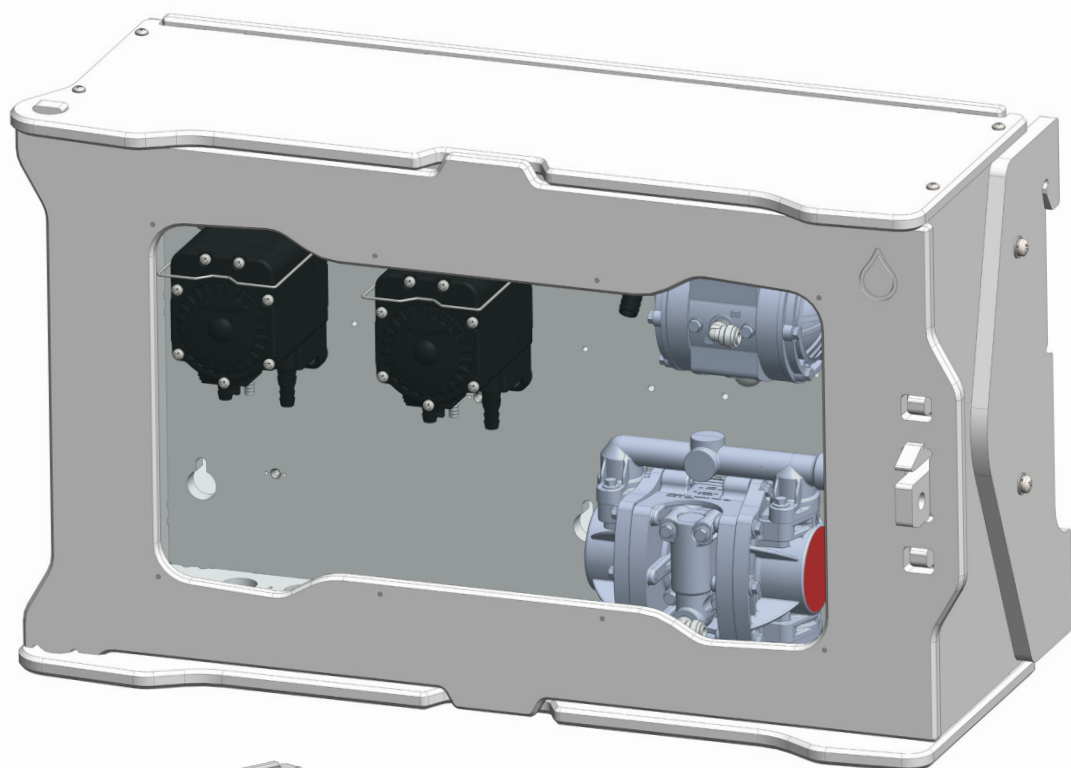

# USER MANUAL: PBX-CAB-25

READ ALL INSTRUCTIONS BEFORE OPERATING EQUIPMENT



## Table of Contents

Overview .....	03
Mounting Cabinet	
Wall Mounting .....	04
Rail Mounting .....	05
Installing Pumps	
Flojet P56 .....	06
Graco 205 .....	07
Other AODD .....	08
Maintenance .....	09



### WARNING:

1. Avoid contact of chemicals with skin and eyes. If contact occurs, see MSDS sheet for further first aid measures.
2. Follow safety instructions of chemical manufacturer (MSDS).
3. Always follow plant and OSHA guidelines about the use of equipment.
4. Disconnect pump before servicing equipment.
5. Always follow safety precautions and obey warning labels. Failure to do so could result in injury or death.

# USER MANUAL: PBX-CAB-25

READ ALL INSTRUCTIONS BEFORE OPERATING EQUIPMENT



## Overview

The Pump Cabinet by Clean Logix provides users a safe and effective way to contain multiple 1/4" pumps to protect users against spills, sprays and other unexpected occurrences that could be hazardous.

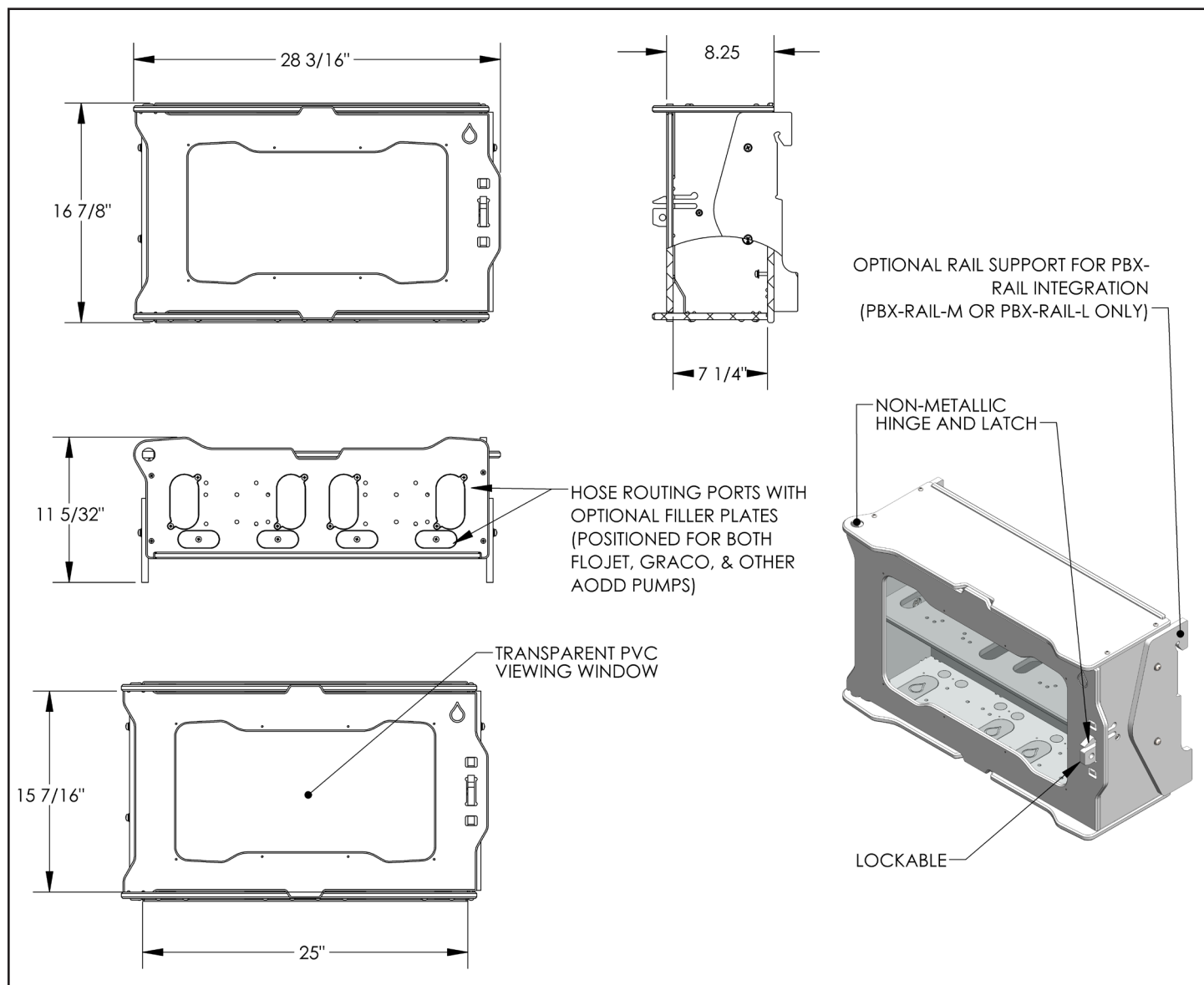

**NOTE:** Shown with Rail Support attached for PBX-RAIL integration.

## Mounting Requirements

The Pump Cabinet by Clean Logix can be mounted in 2 different ways depending on user preference. When determining mounting location and position consider the following:

- Pump accessibility
- Distance from containers and equipment
- Distance from objects/obstacles that may impair hose functionality

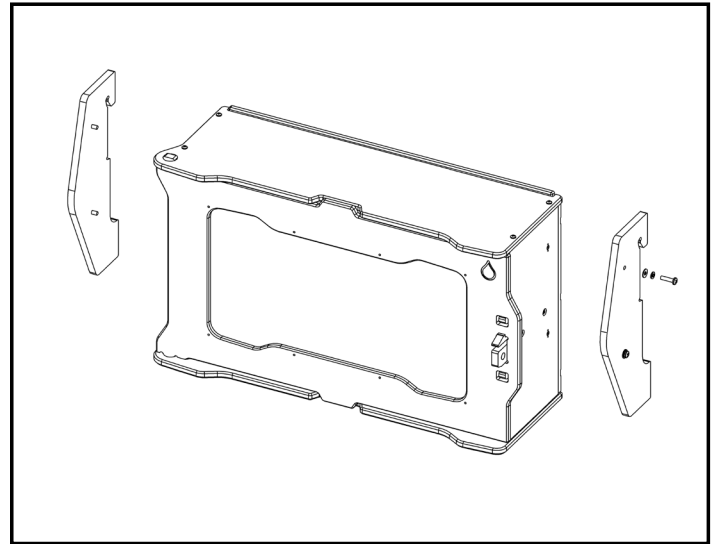
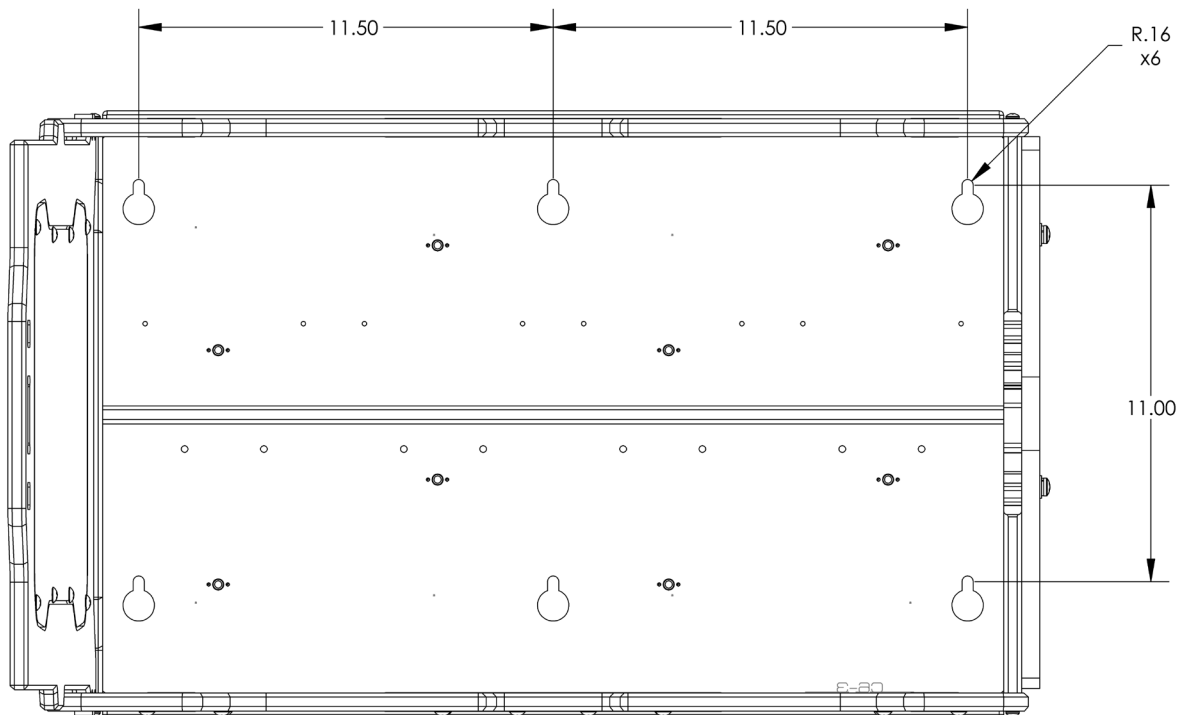

Fig. 3.1: Removing rail supports

## Keyhole Mounting

1. Remove the rail supports on either side of the cabinet [Figure 3.1]
2. Using appropriate hardware (not included) drill and secure the anchor points for the 6 keyholes
3. Mount the cabinet and tighten into place.



## Mounting Requirements (continued)

### Rail Mounting

1. To install the Pump Cabinet on a wall mounted rail (sold separately) attach the rail to the wall using appropriate hardware (not included).
2. Attach the Pump Cabinet to the rail by hooking the rail supports to the top edge of the rail at a slight angle. [Figure 4.1].
3. Let the cabinet rotate back onto the rail and rest against the wall to secure in place [Figure 4.2].

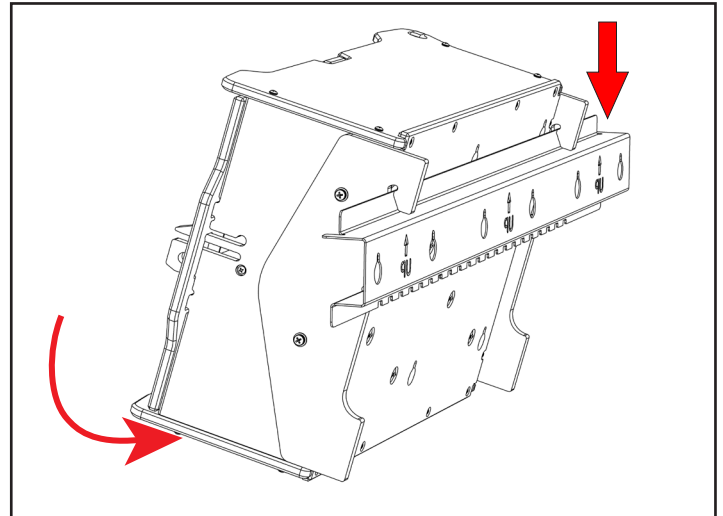
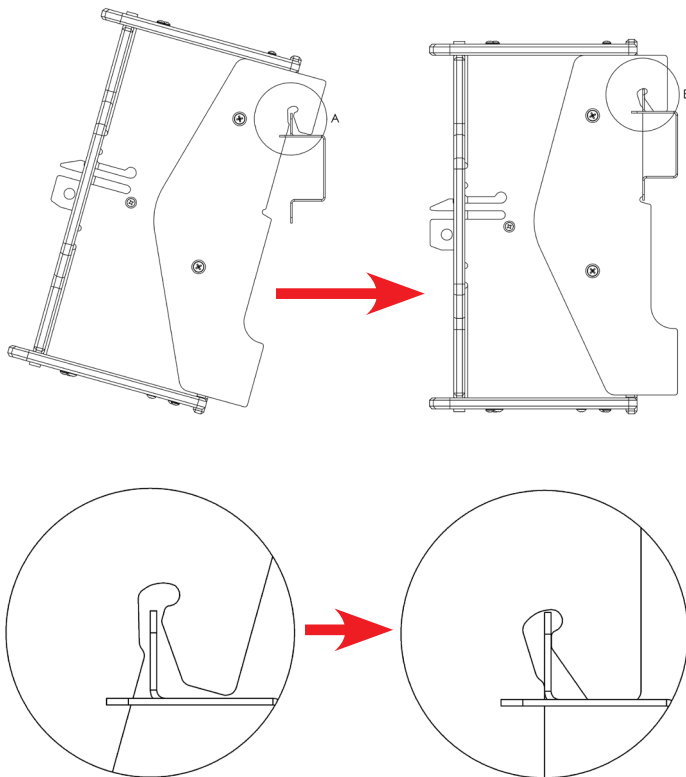

Fig. 4.1: Mounting Cabinet to rail (shown with PBX-RAIL-M)

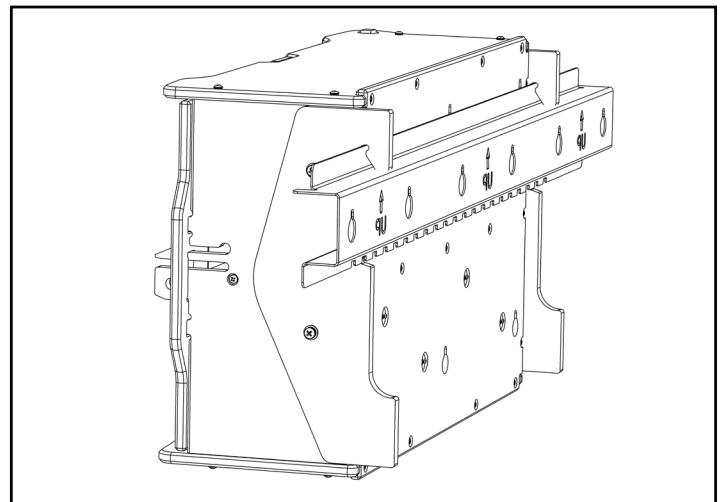

Fig. 4.2: PBX Cabinet attached to rail

4. Position the Pump Cabinet on the rail with clearance for hose routing and additional Pump Cabinets or Boxes.

## Installing Pumps

The PBX Cabinet has been designed to secure a variety of 1/4" pumps:

- Flojet P56
- Graco Husky 205
- ARO
- Wilden P25
- Yamada NDP-5FTP

Review the following sections for suggested installation methods for the pump to be installed.

### Flojet (P56)

1. Open the cabinet and remove the Middle Shelf if installed [Figure 5.1]

- 7 Screws hold the shelf in place (2 on each side, 3 on back panel)

**NOTE:** If the rail supports are installed they will have to be removed temporarily to access 1 of the 2 screws on either side.

2. Using the included self-tapping screws, install the Flojet brackets for each pump to be used as shown in [Figure 5.2].
  - 4 brackets and 8 fasteners have been included for this purpose
3. Using a hammer, insert the dowel pins to their recessed holes as shown in [Figure 5.2].

**NOTE:** 2 dowel pins will be used to support the bottom mounting holes of the Flojet(s).

4. Remove the filler plates for any hose routing ports to be used [Figure 5.3]

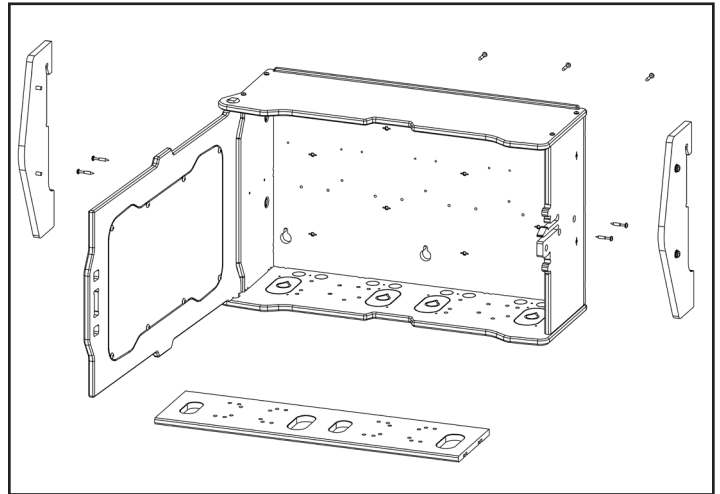

Fig. 5.1: Removing shelf

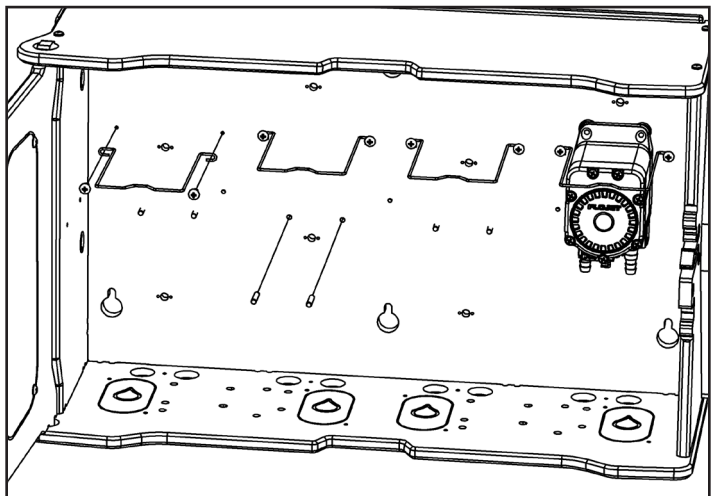

Fig. 5.2: Installing Flojets and mounting hardware

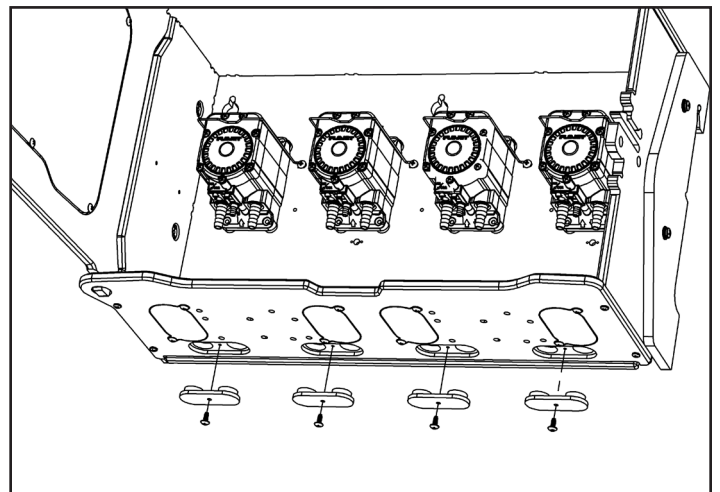

Fig. 5.3: Removing filler plates

## Installing Pumps

### Graco 205

1. Open the cabinet and remove the Middle Shelf if installed [Figure 6.1]

- 7 Screws hold the shelf in place (2 on each side, 3 on back panel)

**NOTE:** If the rail supports are installed they will have to be removed temporarily to access 1 of the 2 screws on either side.

2. Using the included machine screws and washers, install the Graco pumps to the back panel of the enclosure using the pre-installed t-nuts for each pump [Figure 6.2].

- 8 sets of fasteners have been included for this purpose

**NOTE:** It is recommended to install any hose barbs or fluid fittings prior to pump mounting.

3. Remove the filler plates for any hose routing ports to be used [Figure 6.3]

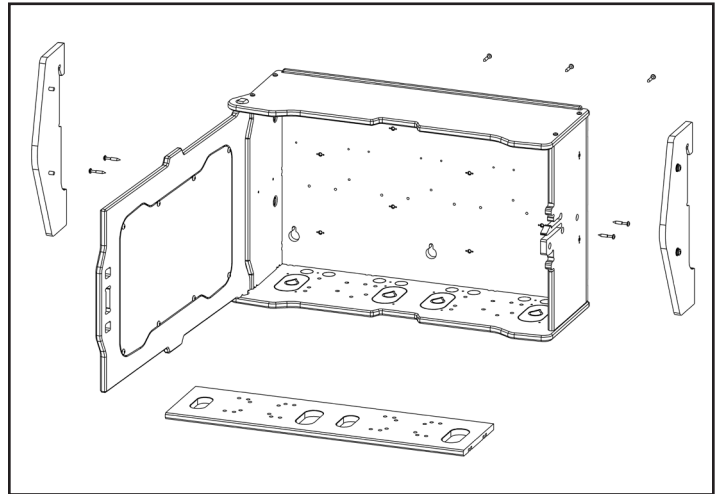

Fig. 6.1: Removing shelf

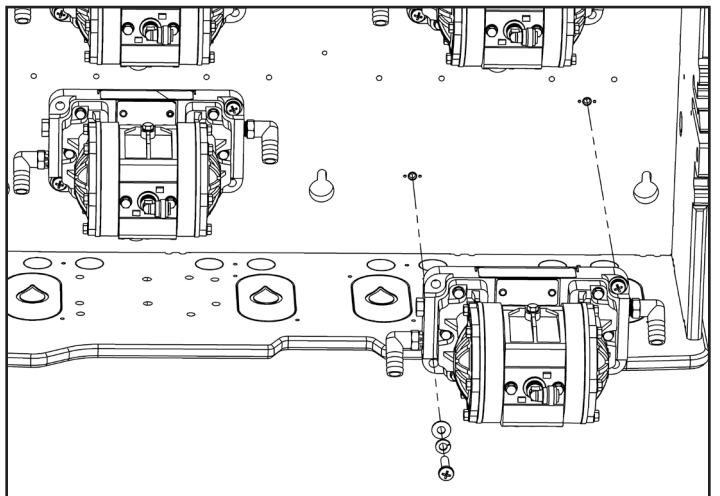

Fig. 6.2: Installing Graco pumps

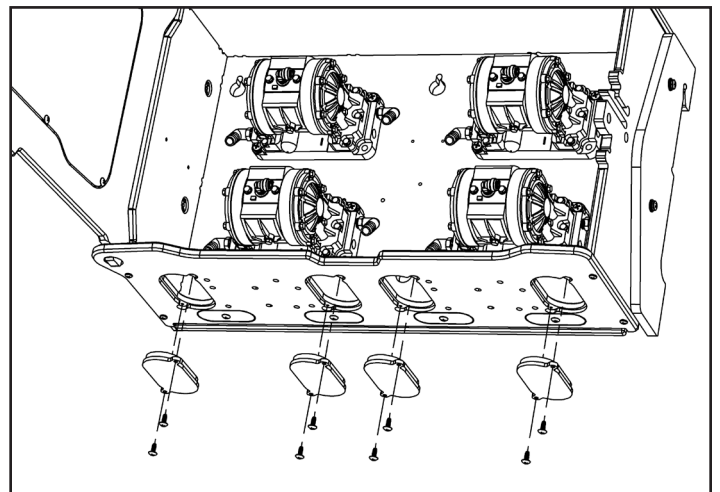

Fig. 6.3: Removing filler plates

## Door Operation & Removal

### Other AODD Pumps (ARO, Yamada, Wilden, etc.)

1. Open the cabinet (if the middle shelf has been removed re-attach it).

**NOTE:** It is recommended to install any hose barbs or fluid fittings prior to pump mounting.

2. Using the 1/4" fasteners or similar (not included) connect each pump, using the pre-drilled holes, to either the bottom or middle shelf [Figure 7.1]

**NOTE:** Top and bottom mounting holes are offset to allow for hose routing clearance between the levels.

3. Remove the filler plates for any hose routing ports to be used [Figure 7.2]

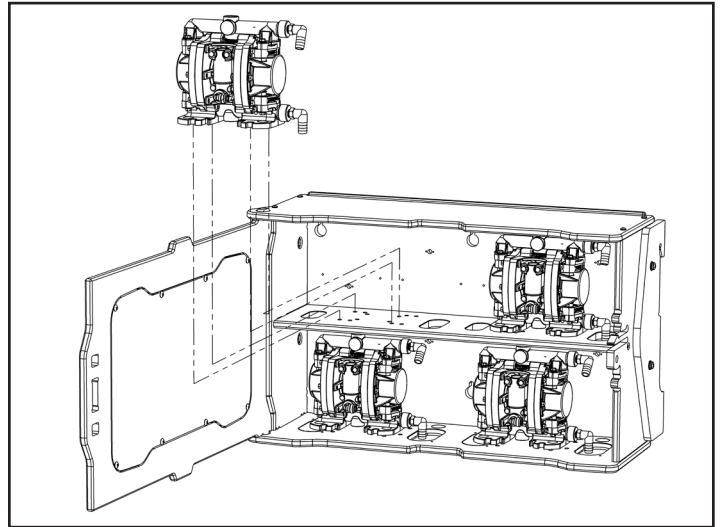

Fig. 7.1: Installing AODD pump (shown with ARO brand 1/4")

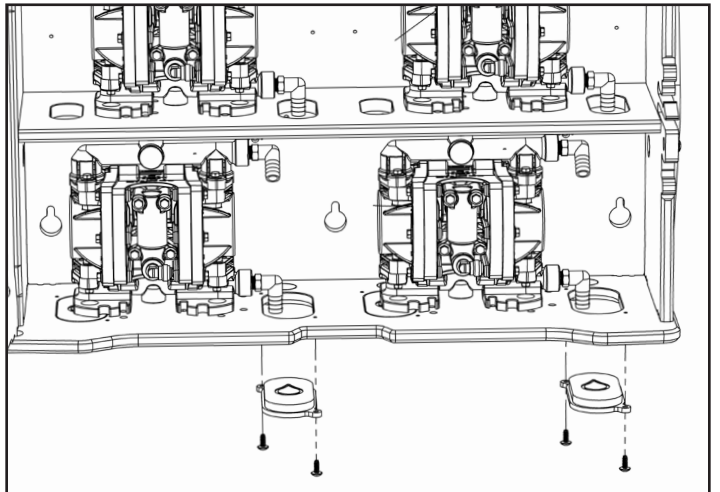

Fig. 7.2: Removing filler plates for ARO option



# USER MANUAL: PBX-CAB-25

READ ALL INSTRUCTIONS BEFORE OPERATING EQUIPMENT



## ***Maintenance***

- Check the enclosure for leaks and/or liquid accumulation.
- Check and adjust plumbing as necessary to prevent and protect against leaks, spills and other plumbing issues.
- Ensure door is latched closed at all times while pump is active.
- Check enclosure and pump mounting plate for cracks or damage.



## WARNING:

Ensure pump is inactive and depressurized before servicing to avoid injury.

Notes:

[illegible]