



USER MANUAL

MODEL:

PBX - 25 / 50 / 100

Pump Enclosure

English (Original Instructions)

Updated: 03/25/21

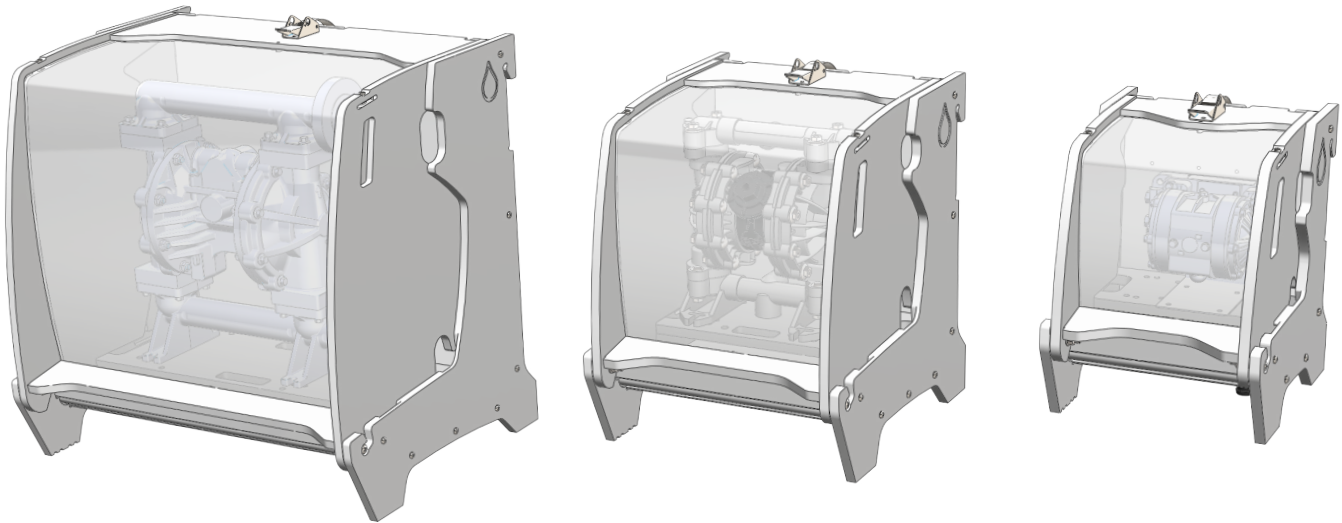

USER MANUAL: PBX - 25 / 50 / 100

READ ALL INSTRUCTIONS BEFORE OPERATING EQUIPMENT



Overview

The Pump Box by Clean Logix provides users a safe and effective way to contain a variety of different sized pumps to protect users against spills, sprays and other unexpected occurrences that could be hazardous.

PBX 25

Graco Husky 205
Graco ChemSafe 205
Yamada NDP-5
Wilden P25 Advanced

PBX 50

Graco Husky 515
Graco ChemSafe 515
Yamada NDP-15
Wilden P100 Advanced

PBX 100

Graco Husky 1050
Yamada NDP-25
Wilden P200 Advanced

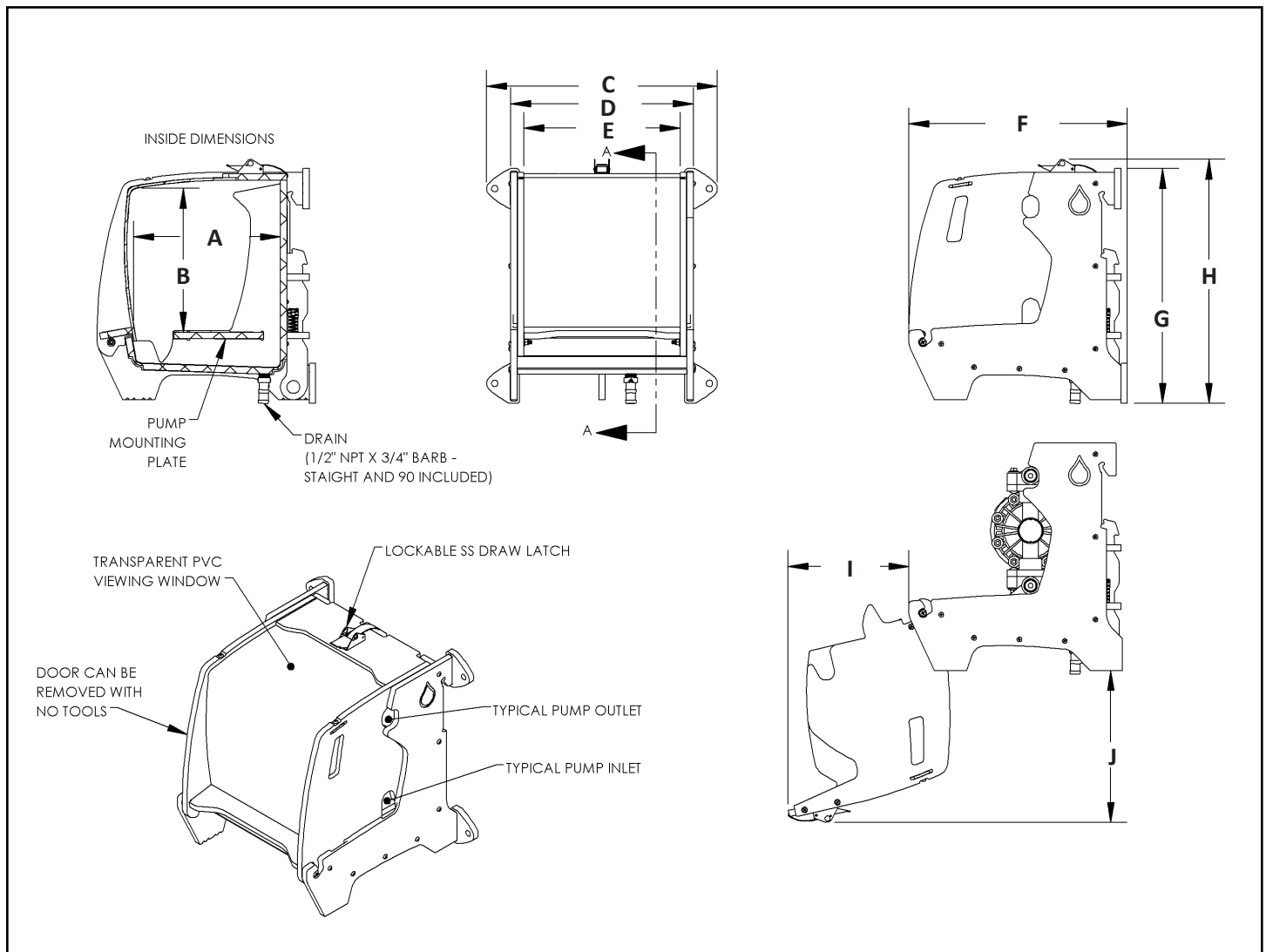

NOTE: Shown with mounting feet for wall installation method. Dimensions will vary depending on model size. Consult dimension tables on pages 3 and 4 for model specific sizing.

Mounting Requirements

The Pump Box by Clean Logix can be mounted in 3 different ways depending on user preference. When determining mounting location and position consider the following:

- Pump accessibility
- Distance from containers and equipment
- Distance from objects/obstacles that may impair hose functionality

Shelf Mounting

1. To mount the Pump Box to an existing shelf attach the four included mounting feet to the bottom of the unit as shown in [Figure 3.1]
2. Attach to the desired shelf with appropriate hardware (not included) [Figure 3.2]
3. Install the included 90 degree hose barb to the bottom drain to allow for adequate hose clearance.

	PBX-25	PBX-50	PBX-100
A	7 11/16"	11 7/16"	13 5/16"
B	7 13/16"	11 1/4"	18"
C	14 1/4"	18"	27 3/4"
D	10 1/2"	14 1/4"	24"
E	8 7/16"	12 3/16"	21 15/16"
F	13 9/32"	17 1/32"	19 13/32"
G	14 13/32"	18 5/16"	24 7/16"
H	15 1/8"	19 1/32"	25 5/32"
I	6 11/32"	9 3/8"	10 3/8"
J	8 1/32"	11 7/8"	18"
K	13"	16 3/4"	14 9/16"
L	8 9/16"	12 1/8"	26 1/2"

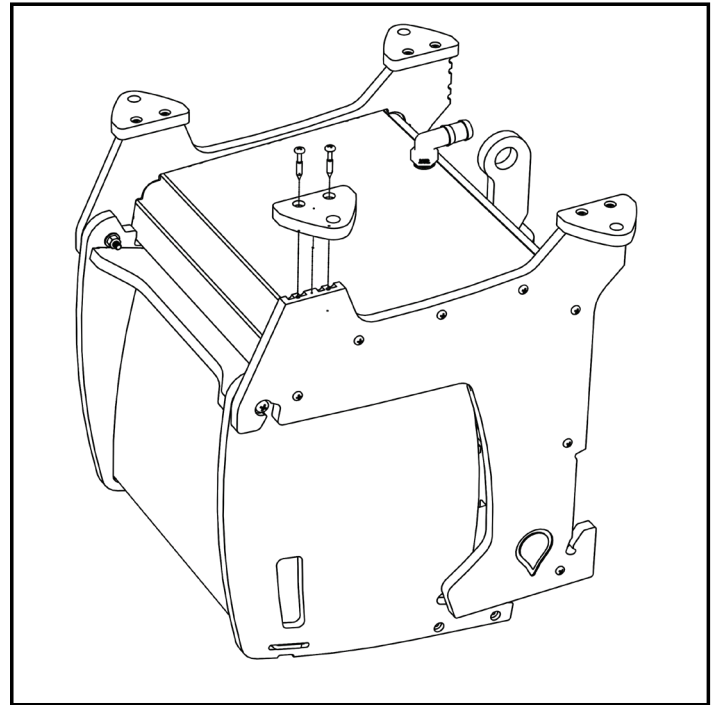

Fig. 3.1: Shelf mounting feet attachment

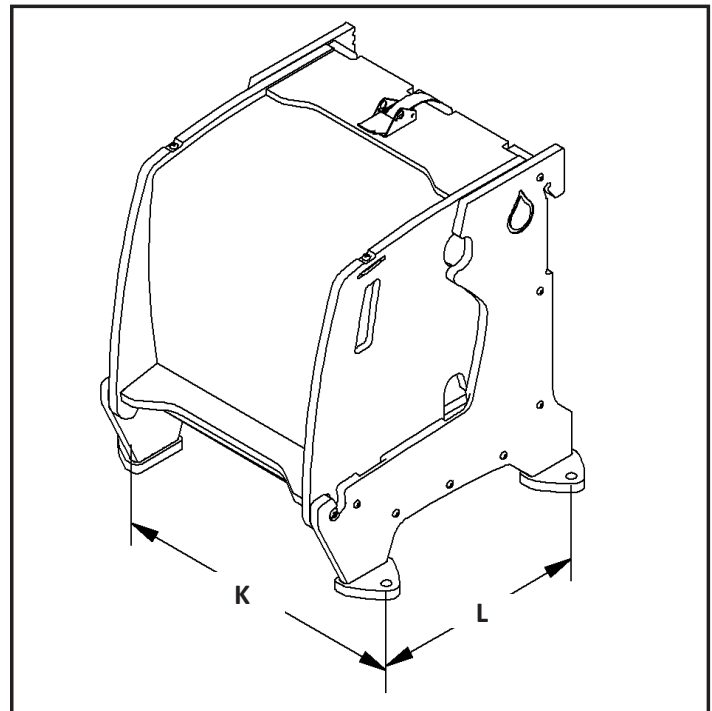

Fig. 3.2: Shelf mounting dimensions

General

Installation

Operation

Maintenance

Mounting Requirements (continued)

Wall Mounting

1. To mount the Pump Box to a wall attach the four included mounting feet to the back of the unit as shown in [Figure 4.1]
2. Attach to the wall using appropriate hardware (not included) [Figure 4.2]
3. Install the included straight hose barb hose barb to the bottom drain to allow for adequate hose clearance.

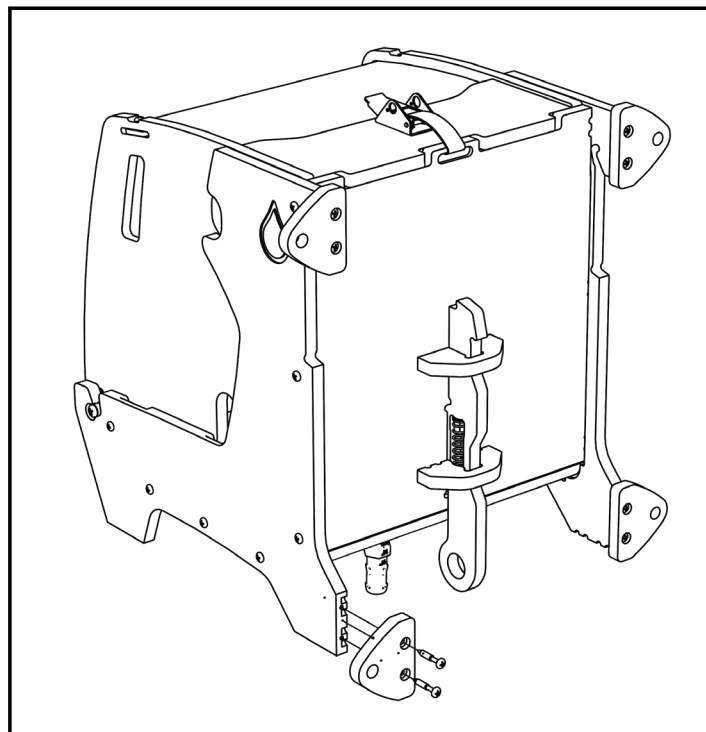

Fig. 4.1: Wall mounting feet attachment

	PBX-25	PBX-50	PBX-100
M	13"	16 3/4"	26 1/2"
N	11 5/16"	15 3/16"	21 5/16"

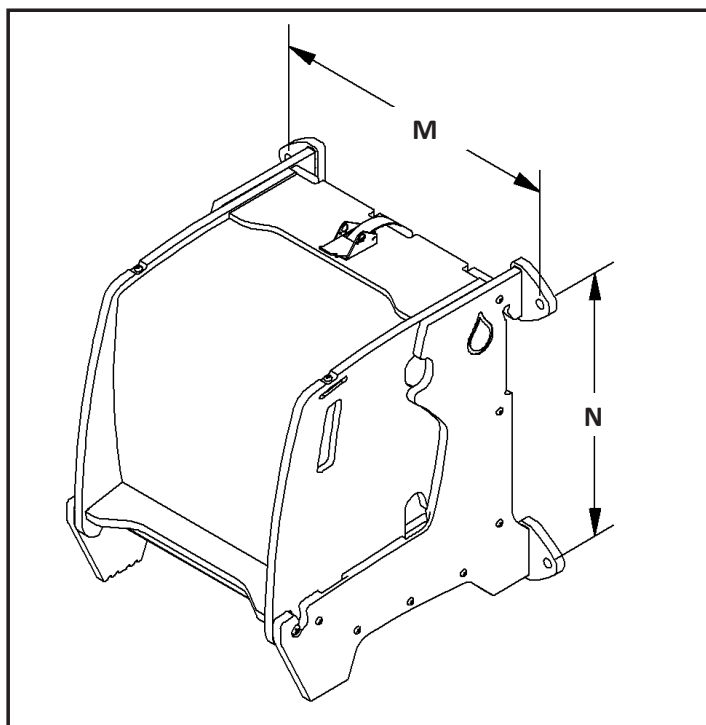

Fig. 4.2: Wall mounting dimensions

Mounting Requirements (continued)

Rail Mounting

1. To install the Pump Box on a wall mounted rail (sold separately) attach the rail to the wall using appropriate hardware (not included).
2. Attach the Pump Box to the rail by releasing the spring-activated rail latch on the back of the Box as shown in [Figure 5.1].

NOTE: Remove the door during mounting to reduce the overall weight and provide easier access to disengage the rail latch. See Page 10 for more information on removing the door.

3. Set the top ridges of the Pump Box onto the rail and push the bottom of the unit onto it.
4. As the unit passes the locking mechanism, release the spring and the box will lock into position. [Figure 5.2]
5. Position the Pump Box on the rail with clearance for hose routing and additional Pump Boxes. [Figure 5.3]

NOTE: Consult the table below for recommended hose sizes and clearance distance based on Pump Box size/model.

6. Install the included straight hose barb to the bottom drain to allow for adequate hose clearance.

Pump Box Model	Hose Size	Clearance Distance
PBX-25	1/2"	4"
PBX-50	3/4"	6"
PBX-100	1"	9"

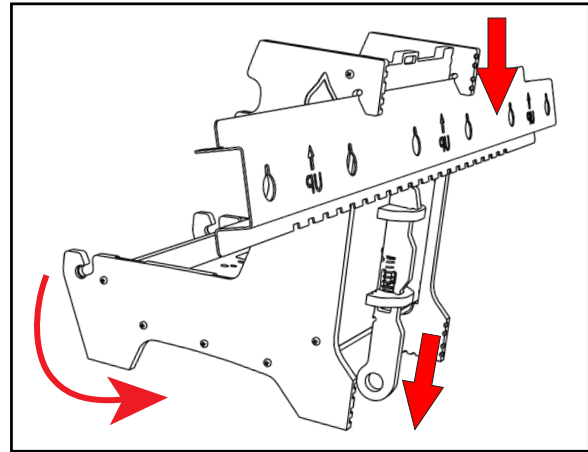

Fig. 5.1: Mounting PBX to rail with disengaged latch

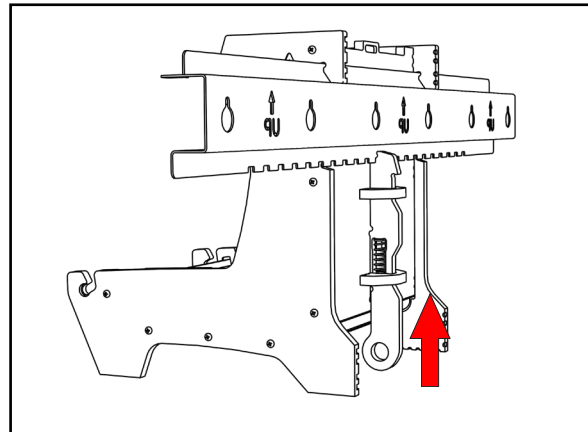

Fig. 5.2: PBX mounted to rail with latch engaged

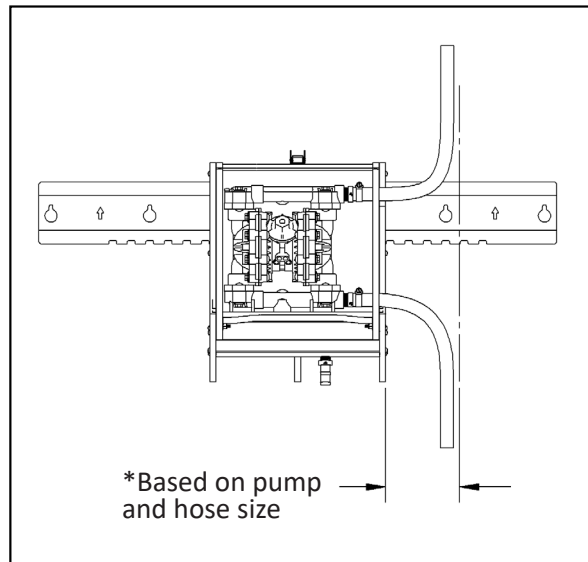

Fig. 5.3: Mounting clearance for rail mounted Pump Box. Shown with Graco Husky 515 pump.

Installation

Installation Set-Up

Regardless of Pump Box size or chosen mounting method, Clean Logix recommends using the following installation set-up. Following these guidelines will ensure maximum functionality of the Pump Box and reduce the likelihood of spills or other unexpected events.

1. Attach a 3/4" hose (not included) to the drain's hose barb, located on the bottom of the unit. Depending on the chosen mounting installation use the following included hose barb for the specified installation method:
 - **Straight Barb** - Wall or rail mounting
 - **90 Degree Barb** - Shelf mounting
2. Secure in place with a hose clamp (not included).
3. Insert or attach the other end of the drain hose into a drain or appropriate container to capture any potential leaks or spills.

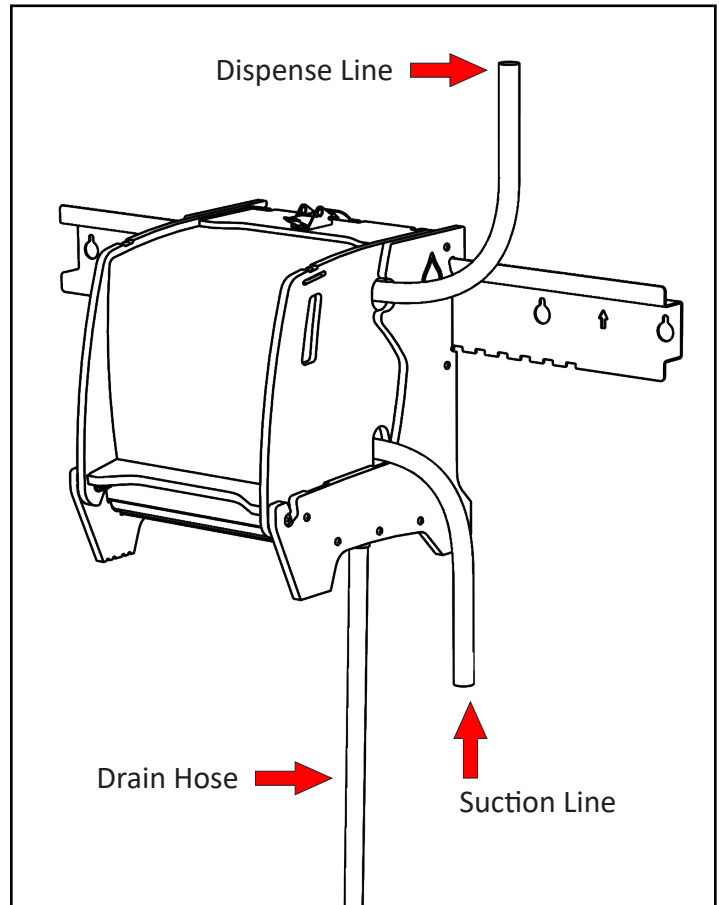
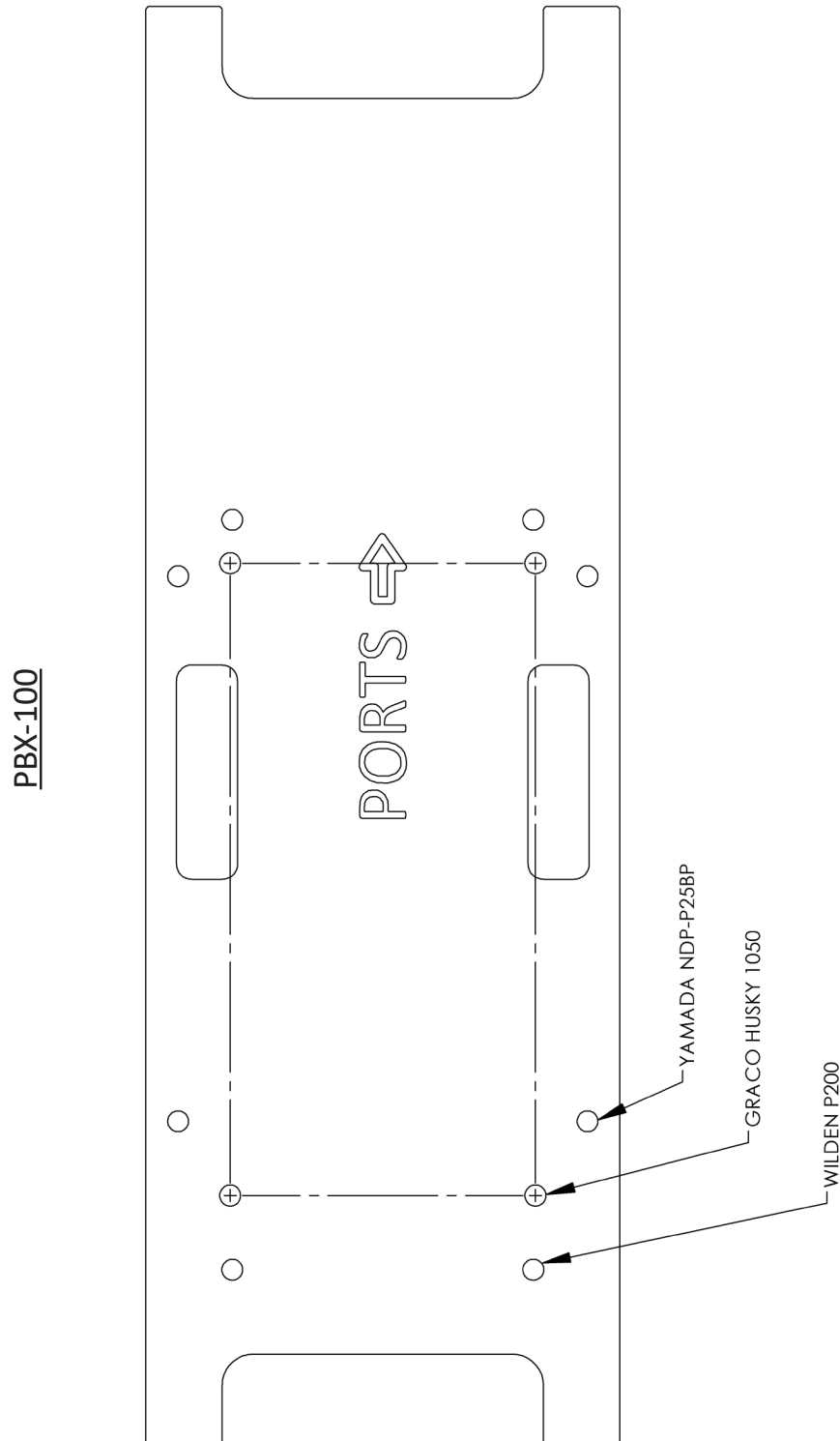

Fig. 6.1: Example Installation set-up.

Mounting Pumps

Each Pump Box model is compatible with a variety of pump sizes and brands. To mount a pump, first identify the mounting holes on the included Plate, inside the Pump Box, based on the PBX model (25, 50, or 100).



General

Installation

Operation

Maintenance

USER MANUAL: PBX - 25 / 50 / 100

READ ALL INSTRUCTIONS BEFORE OPERATING EQUIPMENT



Mounting Pumps (continued)

PBX-50:

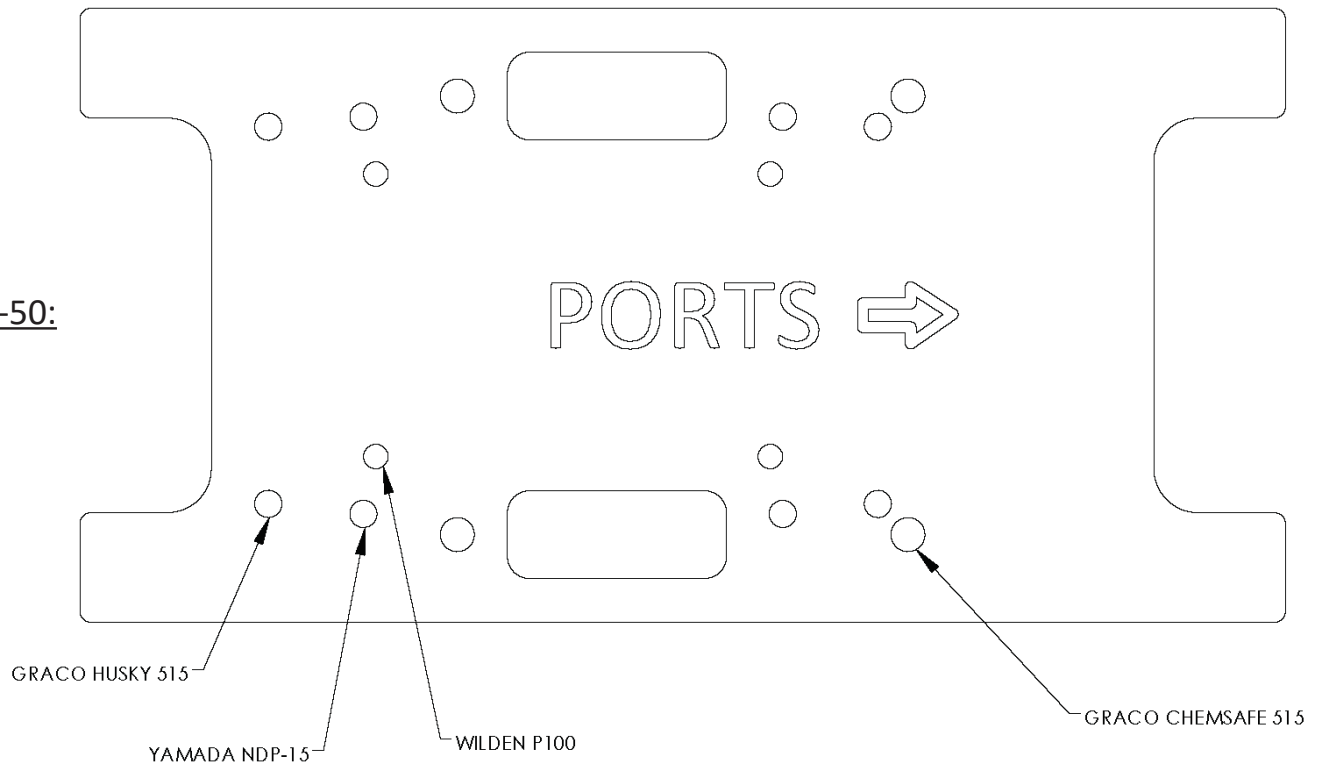

GRACO HUSKY 205 (USE SELF TAPPING #10 SCREWS)
NOTE: FOR THIS PUMP, PORTS FACE OPPOSITE
DIRECTION COMPARED TO ENGRAVED ARROW!

PBX-25:

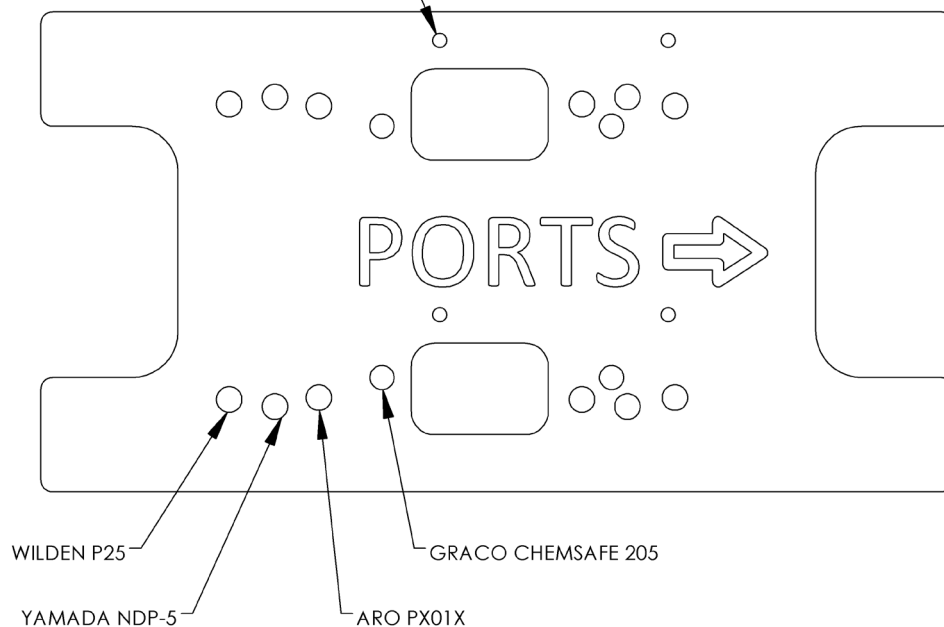

Installing Pumps

1. Securely mount the pump with appropriate hardware (not included) [Figure 9.1].
2. Once secure, re-insert the Mounting Plate, with the ports of the pump oriented to the access ports on the Pump Box, as shown in [Figure 9.2].
3. Plumb the pump with appropriately sized hoses, secure in place with clamps, and slide back into place as shown in [Figure 9.3].

NOTE: Make sure the hose is all the way on the barb before tightening the clamp.

4. Close the enclosure to complete pump installation.

NOTE: If the door is unable to close, ensure the pump plate is completely pushed back and the ports are not obstructed by hoses.

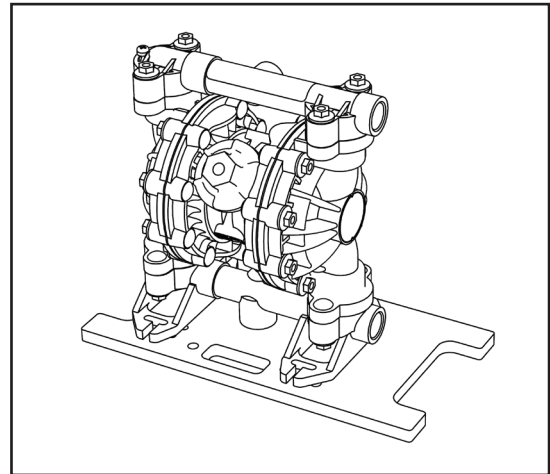

Fig. 9.1: Pump Mounting Plate, shown with Graco Husky 515 pump on PBX-50 plate.

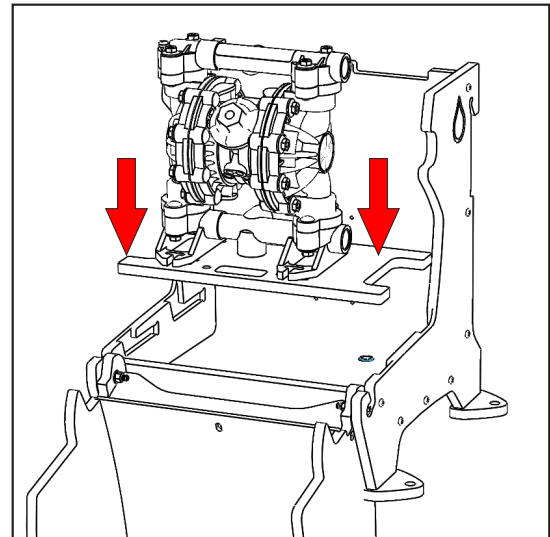

Fig. 9.2: Plate with pump lowered into track

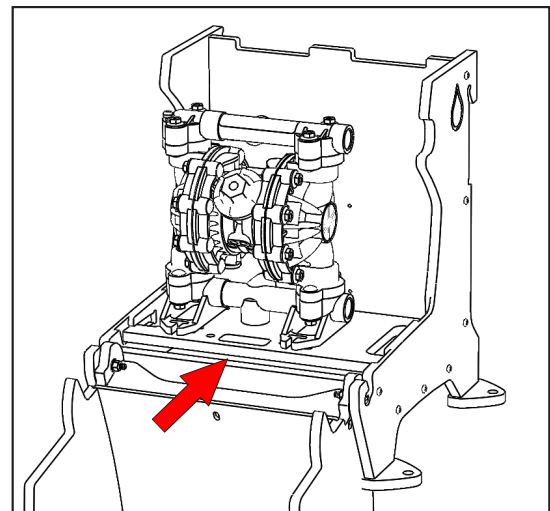

Fig. 9.3: Plate with pump in track at open position

General

Installation

Operation

Maintenance

Door Operation & Removal

Opening the Door

1. Disengage the latch on the top of the unit.
2. Using the side handles, pull the door forward.
3. The door will rest open at its max rotation point and will hang, suspended, from its hinges.
4. Slide the Mounting Plate forward to increase accessibility to the pump for maintenance.

Closing the Door

1. Slide the Pump Mounting Plate back into position, if removed.
2. Push the door up and back into position.
3. Latch the door.

Removing the Door

1. Disengage the latch on the top of the unit and pull the door forward as if to open.
2. A 15 degree mid-point allows the door to slide off its hinges - this point can be identified by the clearance point shown in [Figure 10.3]
3. When this point is reached, pull the door up and out of this track to remove it entirely.
4. To re-attach: slide the door's hinges back on, at same mid-point, and push back into position.

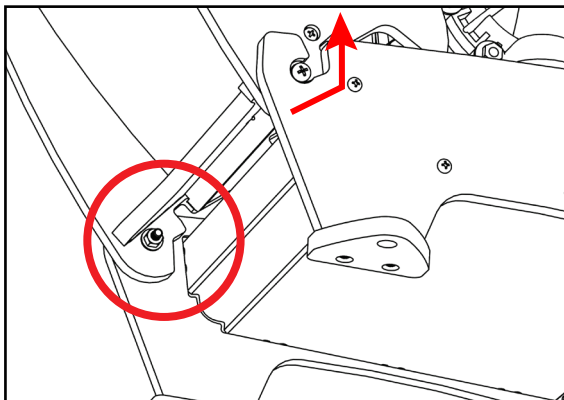

Fig.10.3: Removal position hinge clearance

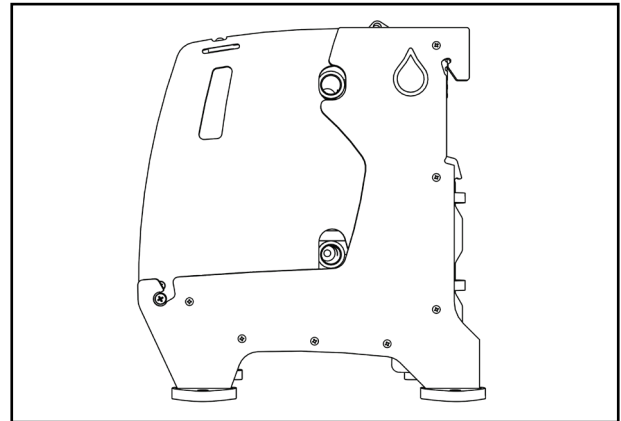

Fig. 10.1: Closed/Locked position

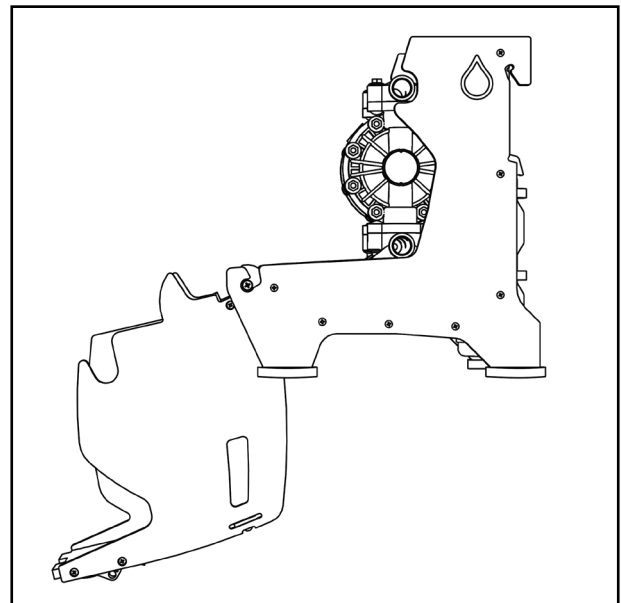

Fig. 10.2: Open position

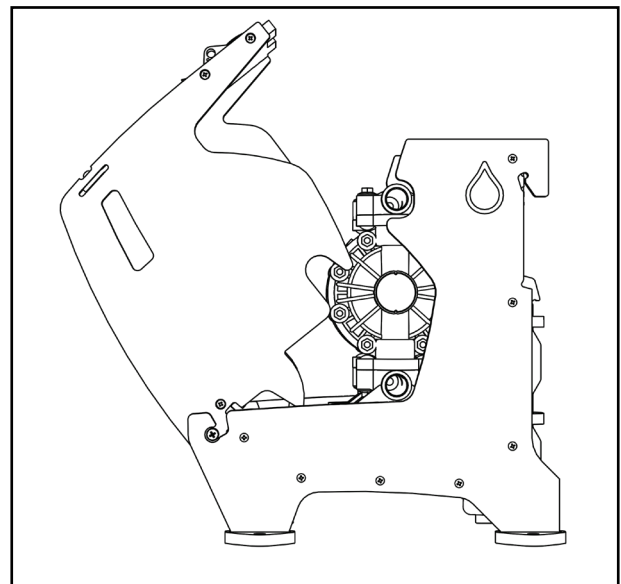

Fig. 10.4: Removal position



Maintenance

- Check the enclosure and drain container (if used) for leaks and/or liquid accumulation.
- Check and adjust plumbing as necessary to prevent and protect against leaks, spills and other plumbing issues.
- Ensure door is latched closed at all times while pump is active.
- Check enclosure and pump mounting plate for cracks or damage.



WARNING:

Ensure pump is inactive and depressurized before servicing to avoid injury.

Notes:

[illegible]

General

Installation

Operation

Maintenance