



USER MANUAL

MODEL:

BLX-100W

Single Manual BootScrubber (Wet)

English (Original Instructions)

Updated: 09/06/24



USER MANUAL: BLX-100W

READ ALL INSTRUCTIONS BEFORE OPERATING EQUIPMENT



Overview

The BLX-100W is an all manual, single footwear scrubbing unit. Designed and built as a solid member, open stainless steel frame with a solid hand rail for support. The BLX-100W features one removable sole brush and four removable vertical side brushes, each of which require no tools. Being a manual based, wet unit the BLX-100W requires no electrical and is pre-configured for easy plumbing of water and sanitizer.



Specifications

- Frame - 304 Stainless Steel
- Length - 28 in.
- Width - 15 in.
- Height - 44 in.

Water Requirements

- Cold Portable Water
- 35 PSI Minimum Pressure
- 100°F Max Temperature

NOTE: A back flow preventer must be installed in the water line for this unit. Check local codes to ensure proper installation

CAUTION:

1. Avoid contact of cleaning agent with skin and eyes. If contact occurs, see MSDS sheet for further first aid measures.
2. Follow safety instructions of chemical manufacturer (MSDS).
3. Always follow plant and OSHA guidelines about the use of hygiene equipment.
4. All personnel using this unit must be familiar with the information contained in this manual. Follow all installation and maintenance instructions.
5. Always wear appropriate footwear. Secure or remove loose items on footwear.
6. Ensure solid footing and use both hands when operating the unit.

WARNING:

DO NOT use flammable liquids (i.e. alcohol based solutions or similar) without dilution.



Installation

Installing and Mounting the Unit

1. Set unit in desired location.
2. Aspects to consider when deciding on placement:
 - Clearance for entering and exiting.
 - Traffic flow for unit operation.
 - Emergency exit paths or egress in case of emergency.
 - Head room for personnel while using the unit.
 - Connections for water.
3. Once the unit is in the desired location, use a level to make sure the unit is stable and level in all directions. Make sure the location is a flat surface.
4. Using the 4 mounting brackets near each corner, securely fasten the unit to the floor with appropriate hardware for the given material (i.e. concrete anchors and bolts) as shown in [Figures 3.1 and 3.2]

WARNING

If not properly secured to floor the unit may tip over and has the potential to cause personal injury.

5. Dosing of sanitizing chemicals into water supply can be accomplished via the included venturi injector.

NOTE: The unit is compatible with most common sanitizers. For further plumbing recommendations please contact Clean Logix.

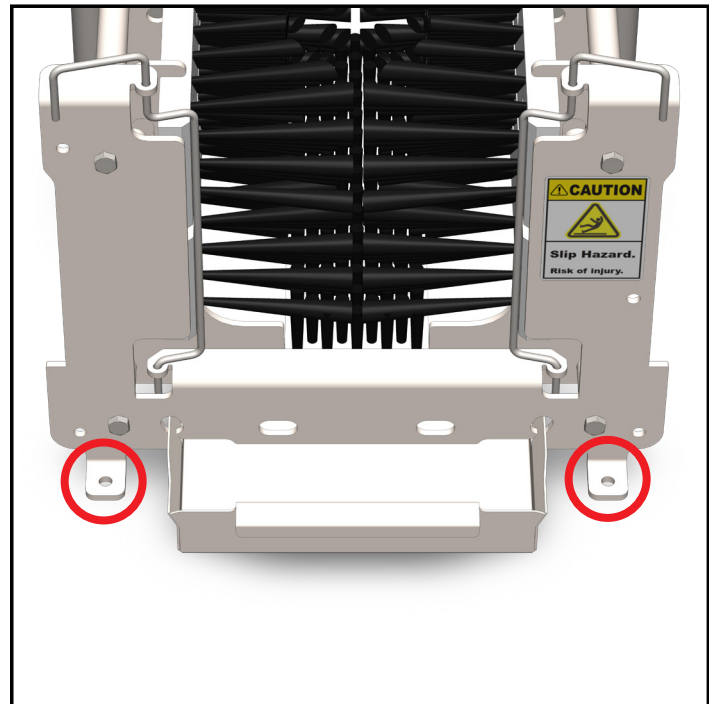

Fig. 3.1: Rear mounting brackets

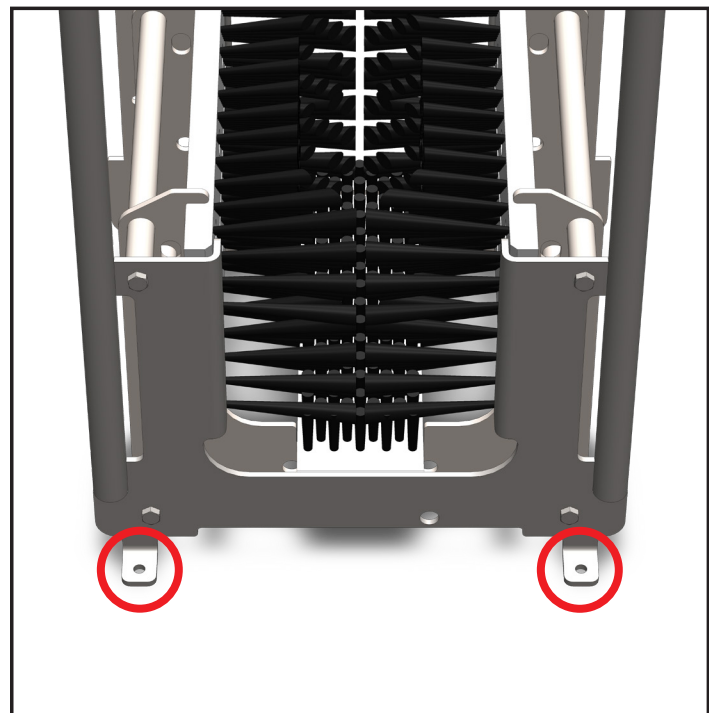

Fig. 3.2: Front mounting brackets

General

Installation

Operation

Appendix

USER MANUAL: BLX-100W

READ ALL INSTRUCTIONS BEFORE OPERATING EQUIPMENT



Installation (continued)

Installing Foot Plate

1. Align the Foot Plate at the opening of the unit.
2. Attach the tabs of the plate to the notches in the unit as shown in [Figure 4.1]

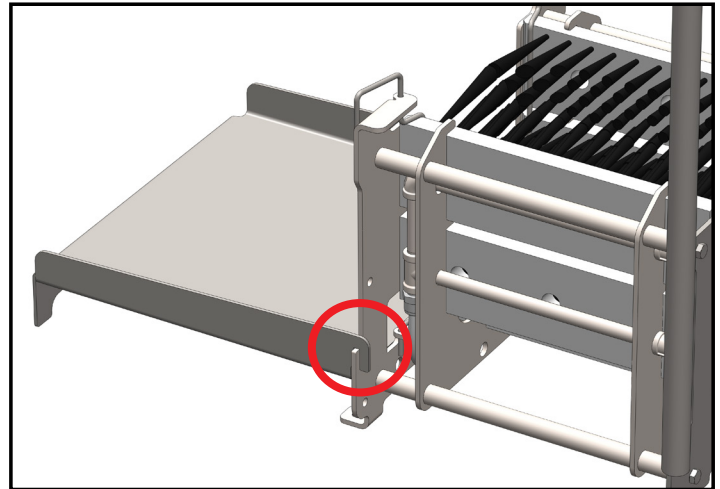
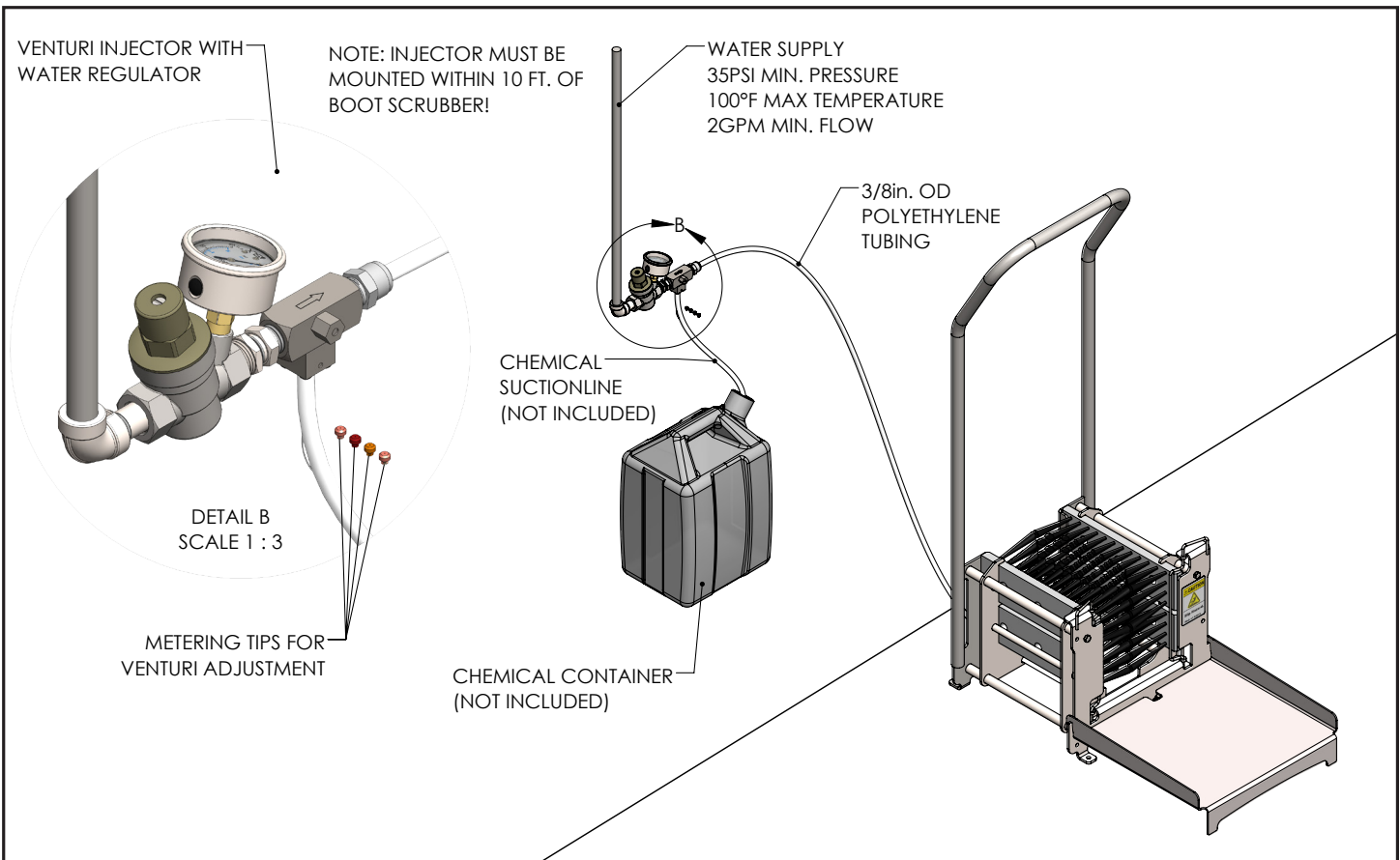

Fig. 4.1: Inserting and attaching Foot Plate

Plumbing

1. Connect the water regulator on the Venturi to the water supply line (regulator thread = 1/2")
2. Using 3/8" OD polyethylene tubing (or similar) connect the sanitizer solution to be used to the Venturi's hose barb, as shown below:

NOTE: A back flow preventer must be installed in the water line for this unit. Check local codes to ensure proper installation.



Installation (continued)

Plumbing (continued)

3. Using the push to connect fitting, connect the Venturi system to the BLX's water line located under the unit, near the foot plate [Figure 5.1]

NOTE: Injector must be mounted within 10 ft. of boot scrubber.

4. Test the system by stepping on the footplate to engage the unit and begin spraying.
5. Adjust the solution output as necessary using the included metering tips (instructions included).



WARNING:

DO NOT use flammable liquids (i.e. alcohol based solutions or similar) without dilution.

Removing Brushes

The brushes are held in place by the brush clip at the front of the unit.

1. To remove the brushes, pull up on the clip and twist them outward, as shown in [Figure 5.2].
2. Once unlocked, the brushes can be removed for cleaning, by slipping them out from their holders.

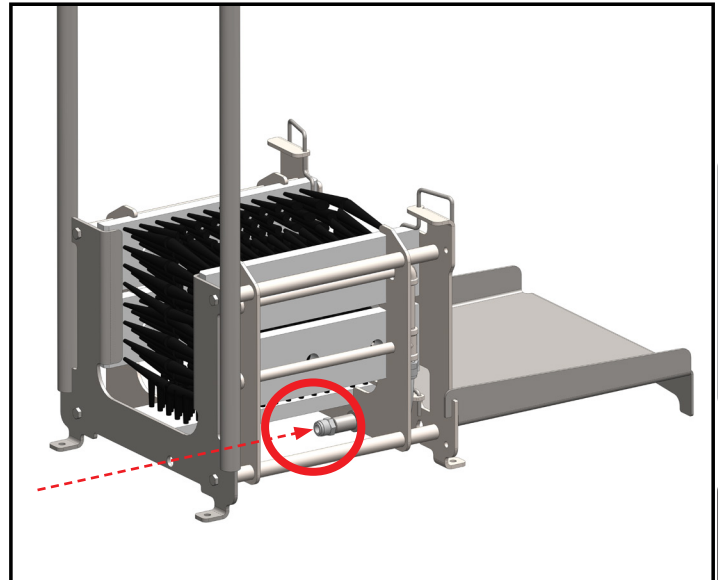

Fig. 5.1: Water line of BLX-100W

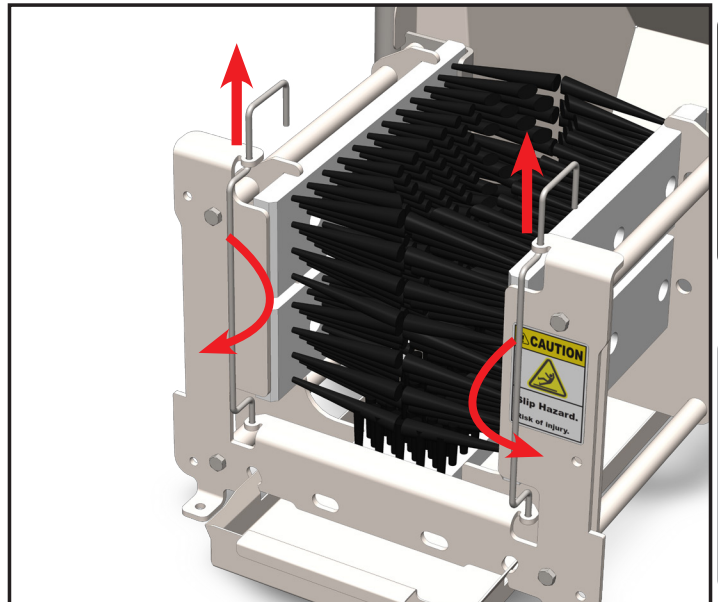

Fig. 5.2: Brush clip rotation for brush removal

General

Installation

Operation

Appendix

Operation

General Use

Prior to use - ensure brushes and foot plate are secured, the system itself properly installed, and that water is both turned on and flowing to the unit's spray bars. To verify water/sanitizer supply; step on the Foot Plate to initiate water/sanitizer flow. Before operating the unit, ensure solid footing and use both hands on the handrail for support.

1. To begin operation, step up onto the Foot Plate and grip the support handrail.
2. Place one boot in the unit.
3. Push the boot back and forth multiple times so every part makes contact with the brushes.
4. Once the first boot is clean, remove it and repeat the process with the second boot.
5. If boots are extremely dirty, it may be necessary to scrub them multiple times.

Cleaning and Wash-Down

1. Shut off water supply to unit and depressurize water lines.
1. Remove the Foot Plate and brushes from the unit.
2. Brushes and Foot Plate can be washed, individually, in a COP tank or wash machine
3. The frame can be washed down by conventional means.

Maintenance

The following maintenance procedures are recommended for normal use. Units which see a high amount of daily use should be inspected more frequently as necessary.

Weekly:

- Inspect brushes for damage or wear.
- Check for missing or deformed bristles.
- Inspect plumbing/water lines for damage
- Ensure solid mounting to floor.

Monthly:

- Check all fasteners to ensure they are tight.
- Ensure warning labels and decals are present and in good condition.
- Inspect valve for damage

Quarterly:

- Inspect structure for cracked welds or bent components.

READ ALL INSTRUCTIONS BEFORE OPERATING EQUIPMENT

[illegible]

General

Installation

Operation

Appendix

USER MANUAL: BLX-100W

READ ALL INSTRUCTIONS BEFORE OPERATING EQUIPMENT



Appendix A - Parts Callout

Venturi Kit:

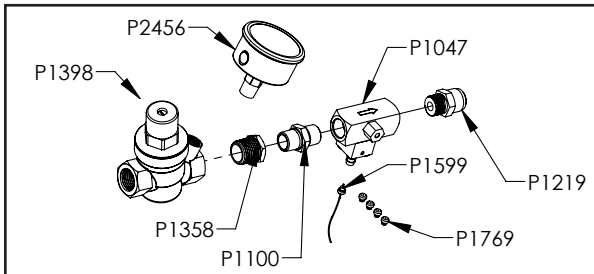

| Part No. | Description |
|----------|---------------------------------|
| F1036 | BOLT HHC 5/16-18 X 3/4 SS |
| F1151 | WASHER 37/64 X 1-1/16 X 1/16 SS |
| M1388 | BRUSH BOX WLDMNT |
| M1391 | HANDLE WLDMNT BLX-100 |
| M1392 | BRUSH CLIP |
| M1393 | FIXED SIDE BRUSH |
| M1394 | FOOT PLATE BLX-100 |
| M1396 | FRONT PLATE BLX MANUAL |
| M1399 | SPRAY BAR BLX MANUAL |
| P1047 | VENTURI INJECTOR 3/8 SS |
| P1100 | PIPE HEX NIPPLE 3/8 SS |
| P1102 | PIPE NIPPLE 1/4 CLOSE SS |
| P1103 | PIPE TEE 1/4 SS |
| P1104 | PIPE ELBOW 1/4 X 90 SS |

| Part No. | Description |
|----------|--|
| P1107 | PIPE ELBOW STREET 1/4" SS |
| P1108 | PIPE CAP 1/4" SS |
| P1196 | PIPE COUPLER 1/4" |
| P1211 | QUICK FIT 1/4 NPT X 3/8 TUBE |
| P1219 | QUICK FIT 3/8 NPT X 3/8 TUBE |
| P1248 | LABEL SLIP HAZARD |
| P1302 | PIPE NIPPLE 1/4 X 3 SS |
| P1338 | METERING TIP, LOW FLOW 100-15KU |
| P1355 | VALVE PUSHBUTTON SS |
| P1358 | PIPE BUSHING 1/2 X 3/8 SS |
| P1398 | PRESSURE REGULATOR WATER 1/2" SS |
| P1599 | METERING TIP, CAPILLARY TUBE |
| P1741 | GAUGE, PRESSURE, 2-1/2" 0-100psi 1/4" NPT SS CENTER BACK MOUNT |
| P1769 | METERING TIPS, ULTRA LEAN 100-15KU |

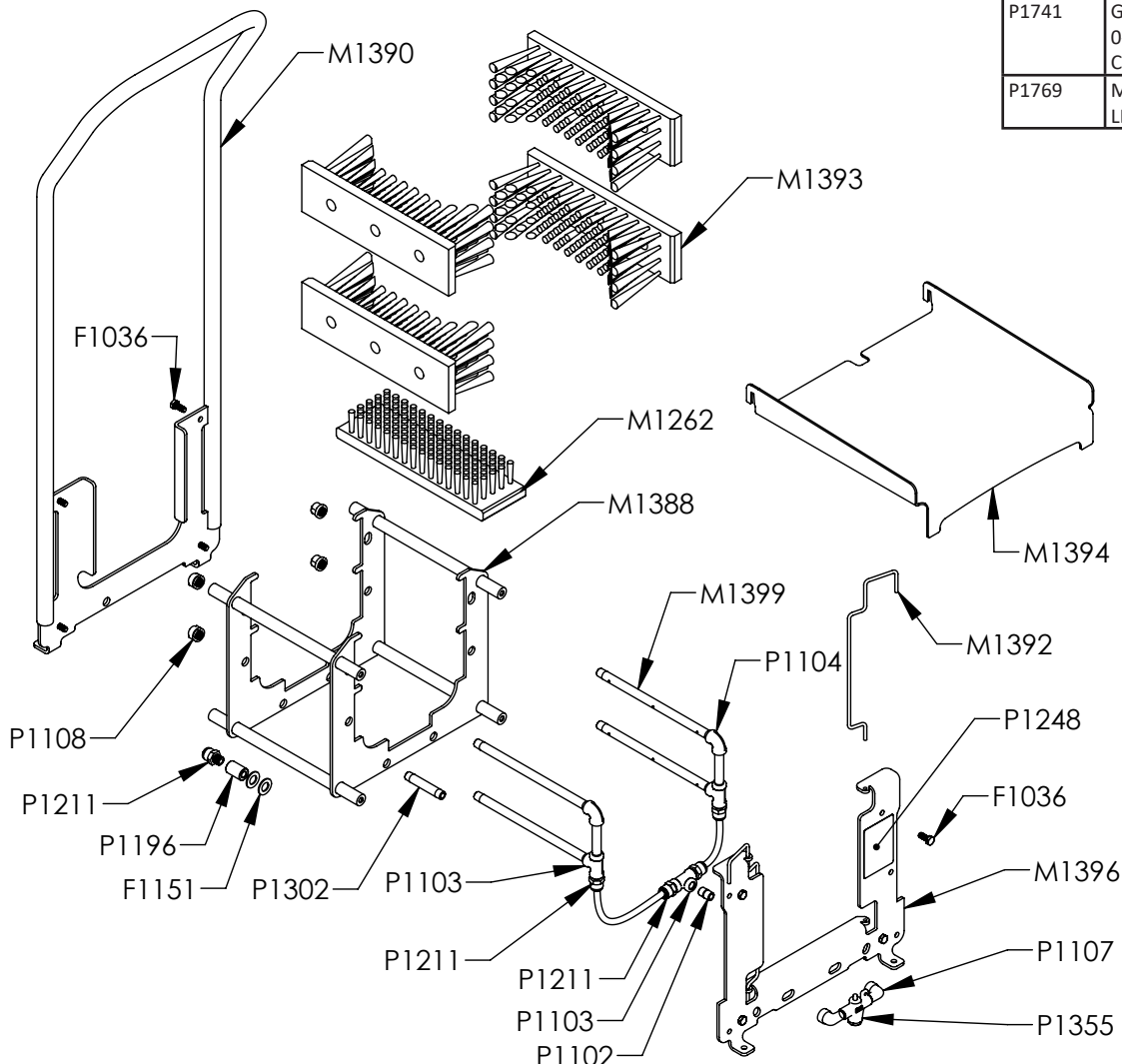

USER MANUAL: BLX-100W

READ ALL INSTRUCTIONS BEFORE OPERATING EQUIPMENT



Appendix B - Dimensions

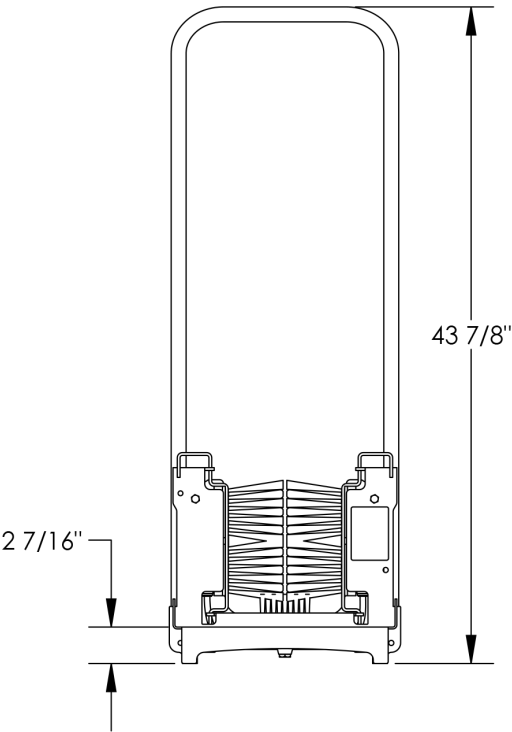
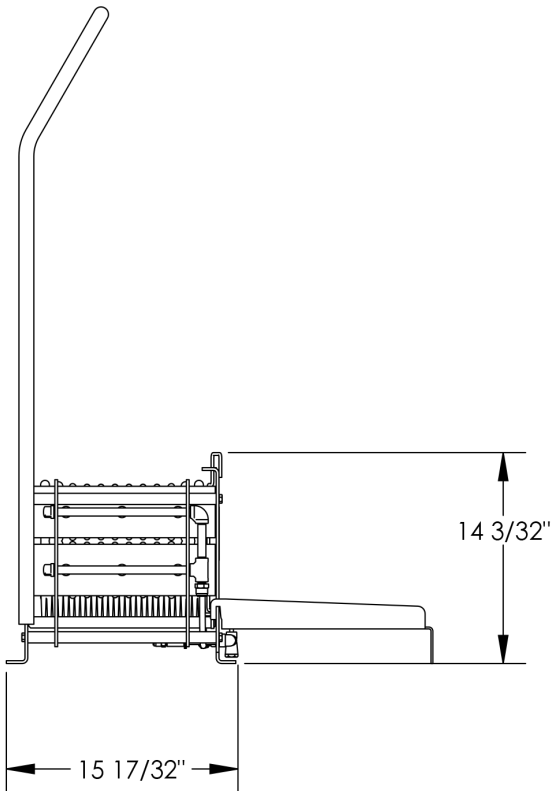
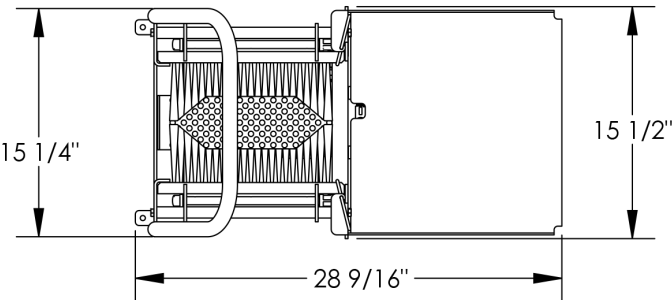

General

Installation

Operation

Appendix