

SLX-VF



VENTURI FOAMER

The SLX wall mounted water driven foamer is the ultimate solution for industrial cleaning applications to quickly and effectively foam equipment, rooms, and other processing areas.

This low to medium volume decentralized foaming system works with city water pressure to foam chemistry and detergents for a range of flow rates to get you the best foam coverage. Simply hook up water, compressed air, and chemistry to start cleaning!

Stainless Steel



Polypropylene

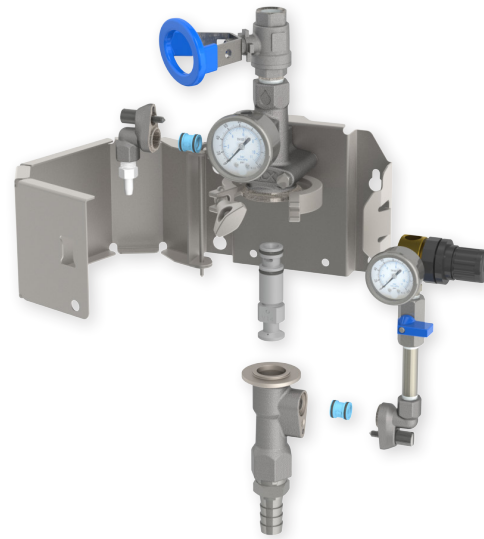

FEATURES:

- Split body design for easy servicing and maintenance (patent pending)
- Tool free maintenance (even the check valves and plumbing components)
- Large fan nozzle for efficient foam spray coverage
- Adjustable consistency (dry vs. wet foam)
- Modular components to alter flow rates
- Heavy duty, durable construction
- Lockable stainless-steel cover
- Includes pressure gauges for air and water
- Large stainless steel ball valves at inlet and outlet with 1/2" NPT connections

Dimensions	8" x 12-7/8" x 5-1/2"
Flow Rate*	0.6 - 4.2 GPM
Max Temperature	160°F
Water Pressure	35-125 PSI
Air Pressure**	40 PSI (up to 5 CFM**)

*Flow rate and CFM will vary depending on insert size.

**Air pressure recommended 40PSI, adjust for foam quality.

INCLUDES:

- Foamer with polypropylene or stainless steel body
- PVC venturi insert (dependent on flow rate)
- Stainless steel mounting bracket and lockable cover
- Color coded metering tips
- 6' suction line with strainer and ceramic weight
- 40'-50' blue discharge hose (dependent on flow rate)
 - Other colors available
- Polypropylene foaming wand
 - Stainless-steel upgrade available

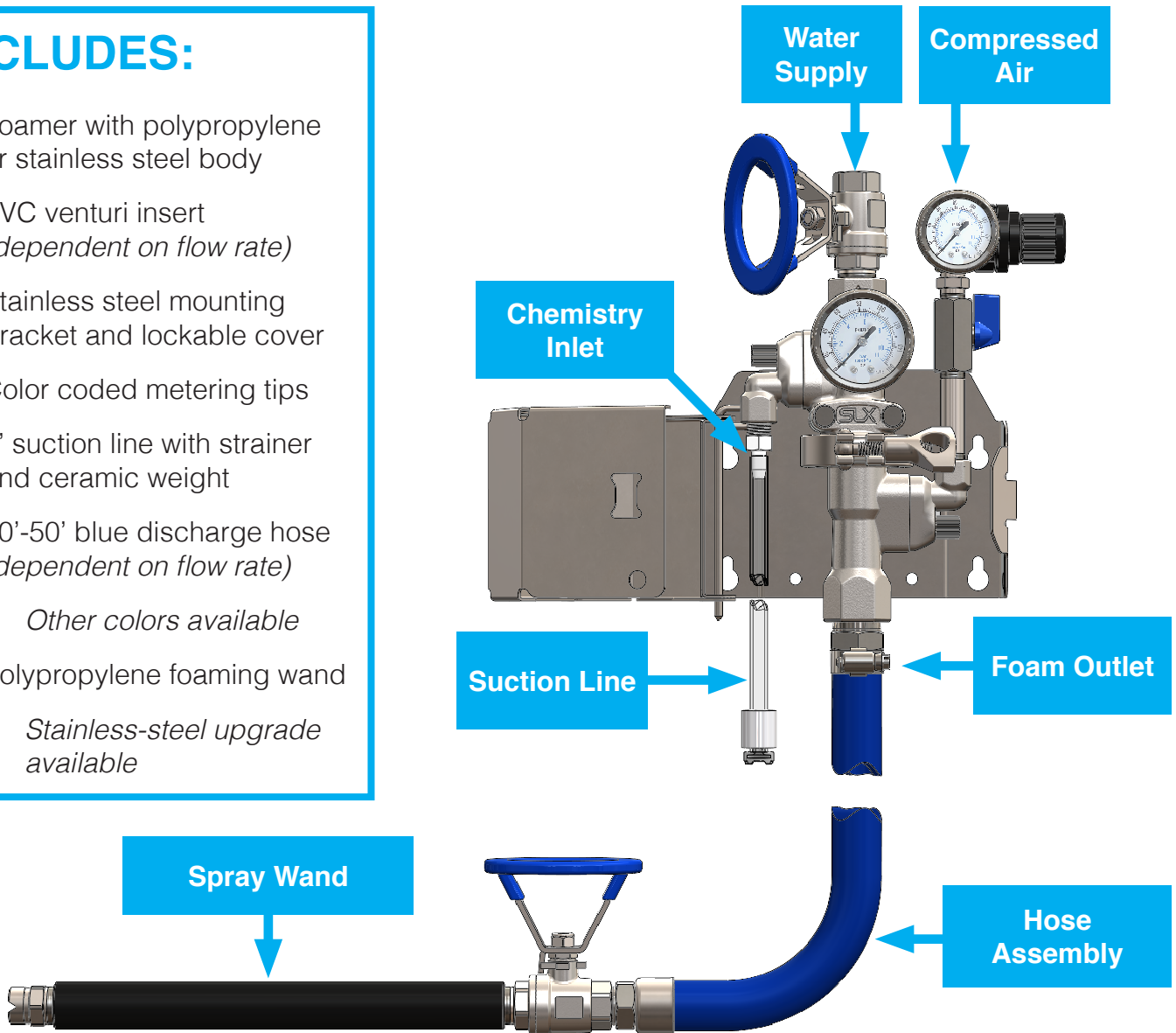

Stainless steel body shown

SPECIFICATIONS

Insert #	Coverage Time (500 sq/ft)	Foam Flow Rate	Water Flow Rate	Hose Size	Spray Nozzle	Dilution Ratios
V06	4.5 min.	3 - 6	0.6	3/4" x 40'	80150	174:1 - 1.5:1
V14	2 min.	7 - 14	1.4	3/4" x 50'	50250	407:1 - 4:1
V37H	1.5 min.	18.5 - 37	3.7	1" x 50'	00400 or 50400	1047:1 - 9:1
V42	1 min.	21 - 42	4.2	1" x 50'	00400 or 50400	1265:1 - 11:1

PART NUMBER ARCHITECTURE

SLX-VF [insert size] [body material] - [option]

06, 14, 37H, 42

S = Stainless Steel
P = Polypropylene

Blank = 1 chemical inlet
2 = 2 chemical inlets

ex) **SLX-VF14S** = Venturi Foamer with V14 insert, stainless steel body, and 1 chemical inlet.